

BAMBA

SKINCARE IPL QUARTZ

IPL compacta con lámpara de cuarzo / Compact IPL with quartz lamp



cecotec

Manual de instrucciones
Instruction manual
Manuel d'instructions
Bedienungsanleitung
Manuale di istruzioni
Manual de instruções
Instrukcja obsługi
Návod k použití

INDEX

1. Contraindications, precautions and side effects	40
2. Parts and components	42
3. Before use	42
4. Operation	42
5. Cleaning and maintenance	48
6. Troubleshooting	48
7. Technical specifications	49
8. Disposal of old electrical appliances	49
9. Technical support and warranty	49

SAFETY INSTRUCTIONS

Read these instructions thoroughly before using the appliance. Keep this instruction manual for future reference or new users.

This appliance is intended for home use only.

This appliance is only intended for removing unwanted body hair from areas below the cheekbones. Do not use it for any other purpose.

Use only as described in this manual. Use only accessories recommended by Cecotec.

Check that the mains voltage corresponds with the rating of the appliance before operating.

Check the power cord for visible damage. If the cord is damaged, it must be replaced by the official Technical Support Service of Cecotec, in order to avoid any type of danger.

Do not immerse the whole unit into water or other liquids.

Never pull the supply cord to unplug it. Instead, grasp the plug firmly and pull to disconnect it.

Never leave your appliance unattended when it is switched on.

Do not look at the light directly.

Do not use the device on tanned skins or after recent sun exposure. It could cause serious damage to skin.

Do not use the device if the vent in the skin contact surface or skin colour sensor is cracked, broken, detached or missing.

Do not use the device if the outer shell is cracked or coming apart.

Always unplug the device immediately after use, before cleaning or carrying out maintenance tasks.

Do not use the device in the presence of flammable gases such

as oxygen or nitrous oxide.

Keep the appliance and the adapter dry.

Do not use the appliance in wet surroundings (e.g. near a filled bath or swimming pool or in a running shower).

If the appliance is broken, do not touch any inner part to avoid electric shock.

Never insert any objects into the appliance.

Only use the adapter supplied.

Make sure that nothing obstructs the air flow through the ventilation slots.

Never subject the appliance to heavy shocks and do not shake or drop it.

If you take the appliance from a very cold environment to a very warm environment or vice versa, wait approximately 3 hours before you use it.

Store the appliance in its original box so that it does not become dusty.

Do not expose the appliance to temperatures lower than 10 °C or higher than 35 °C during use.

To prevent damage, do not expose the appliance to direct sunlight or UV light for several hours.

Do not flash against any other surface than the skin. This can cause severe damage to the light exit window or the skin colour sensor.

Only flash when the appliance is in contact with the skin.

Use this appliance only at intensity levels suitable for your skin colour. Use at higher levels than those recommended can increase the risk of skin reactions and side effects.

Do not attempt to open or repair the device. Opening the device may expose you to dangerous electrical components and to intense light, either of which may cause bodily damage and/or eye injury.

This appliance is not intended for use by persons (including children) with reduced physical, sensory or mental capabilities, unless they have been given supervision or instruction concerning use of the appliance by a person responsible for their safety.

Children should be supervised to ensure that they do not play with the appliance.

The appliance is not intended for children under the age of 15 years. Teenagers aged between 15 and 18 years can use the appliance with the consent and/or assistance of their parents or the persons who have parental authority over them. Adults from 19 years and older can use the appliance freely.

1. CONTRAINDICATIONS, PRECAUTIONS AND SIDE EFFECTS

Tanned skin, especially after sun exposure, contains large quantities of melanin pigment. This exposes the skin to higher risk when using this type of devices and could result in burns, blister and skin colour changes (hyperpigmentation or hypopigmentation).

Note: Avoid exposure to sun for 4 weeks before using the device.

Do not use the appliance:

If you are pregnant or nursing.

If your skin was exposed to strong sunlight or artificial tanning during the past 2 weeks.

If your natural hair is white, grey, golden or red.

If you have a naturally brownish black or darker skin.

Near or around the eyes.

On a tattoo or permanent makeup in the treatment area.

On dark spots, such as large freckles, birthmarks, moles or warts in the treatment area.

If you have eczema, psoriasis, lesions, open wounds or active infections in the treatment area.

If you have a history of collagen disorder, including keloidal scar formation or poor wound healing.

If you have a known sensitivity to light or take medication that makes your skin more sensitive to light. Medicines known to have this effect include non-steroidal anti-inflammatory agents, (e.g., aspirins, ibuprofens, acetaminophen), tetracyclines, phenothiazines, thiazide, diuretics, sulfonylureas, sulphonamides, DTIC, fluorouracil, vinblastine and griseofulvin.

If you are or were recently treated with Alpha-Hydroxy Acids (AHAs), Beta-hydroxy Acids (BHAs), Retin-A®, Accutane® (isotretinoin), topical retinoids, azelaic acid or steroids.

If you have abnormal skin conditions due to diabetes or another systemic or metabolic disease.

If you have a history of herpes outbreaks in the treatment area, unless you have consulted your doctor and received preventive treatment.

If you have a disease that causes light sensitivity, such as porphyria, polymorphic light eruption, lupus, solar urticaria, etc.

If you suffer from epilepsy with flashlight sensitivity.

If you have a history of skin cancer or potential malignancies in the treatment area.

If you have received radiation therapy or chemotherapy within the past 3 months.

If you have an implant, such as a pacemaker or insulin pump, in the treatment area.

If you have any other condition which in your physician's opinion would make it unsafe for you.

Do not use the appliance on nipples, areolas, labia minora, vagina, anus and the inside of the nostrils and ears.

Men must not use it on the face or on the scrotum.

When to consult your doctor

If you take prescribed medication or receive regular medical monitoring because of a certain condition, consult your doctor before you use the device. You should also consult your doctor if you are not sure if the appliance is suitable for you.

To avoid adverse effects:

Do not treat the same area of skin more than once during a session.

Always shave the treatment area before treatment and make sure that the skin in the treatment area is clean and dry.

Do not clean the skin with flammable liquids, such as alcohol or acetone, before you use the appliance.

Possible side effects

Complications associated with the use of IPL hair removal devices are uncommon. However, every cosmetic procedure, including those designed for home use, involves some degree of risk.

Therefore, it is important that you understand and accept the risks and complications that can occur with intense pulsed light hair removal systems designed for home use.

Your skin may show slight redness and/or may tingle or feel warm. This reaction is absolutely harmless and disappears quickly.

A skin reaction similar to sunburn may occur on the treated area for a short while. If this does not disappear within 3 days, we advise you to consult a doctor.

Dry skin and itching may occur due to shaving or a combination of shaving and light treatment. This is harmless and disappears within a few days. You can cool the area with an ice pack or a wet facecloth. If dryness persists, you can apply a non-scented moisturiser to the skin 24 hours after the treatment.

Minor skin discomfort.

Skin redness.

Increased skin sensibility.

Skin wounds and burns. Very rarely, burns or wounds to the skin can occur following use of the device. The burn or wound can require a few weeks to heal and, extremely rarely, may leave a noticeable scar.

Scarring. Although very rare, scarring may occur. Usually when scarring occurs, it is in the form of a flat and white lesion on the skin (hypotrophy). However, it can be large and red (hypertrophic) or large and extend beyond the margins of the injury itself (keloid). Subsequent aesthetic use may be required to improve the appearance of the scar.

Excessive redness and swelling. Very rarely, the skin of the hair removal area skin may become very red and swollen. This is more common in sensitive areas of the body. The redness and swelling should subside within 2 to 7 days. Application of ice may help to reduce

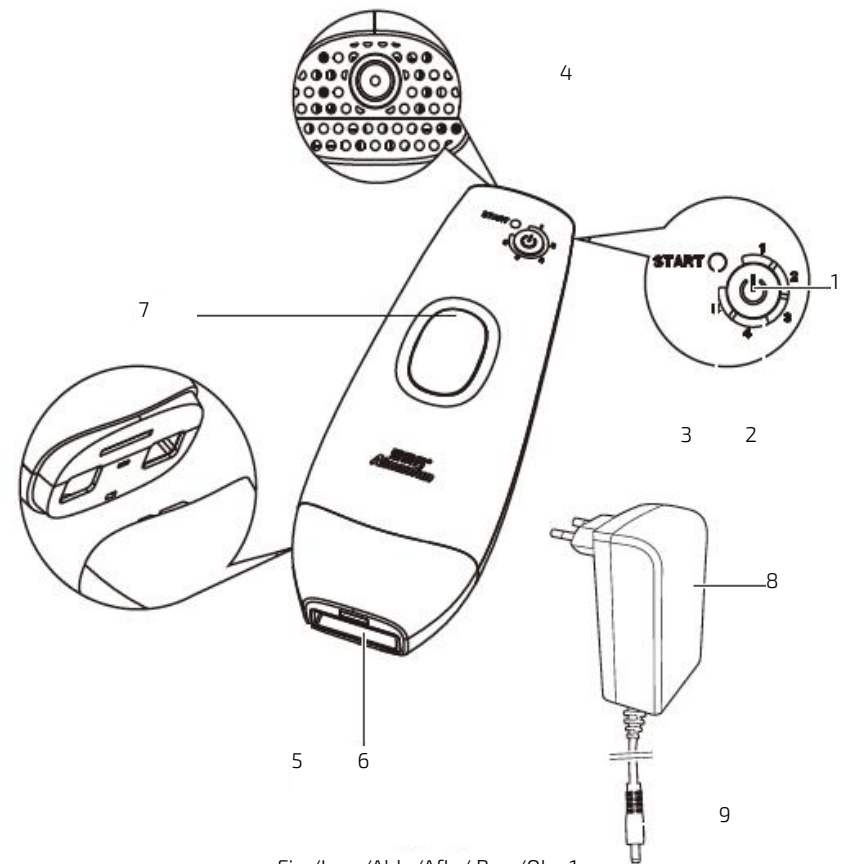

Fig./Img./Abb./Afb./ Rys./Obr. 1

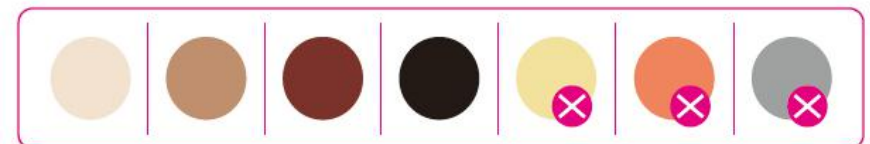

Fig./Img./Abb./Afb./ Rys./Obr. 2

the welling. Gentle cleaning of the skin is allowed, but exposure to the sun should be avoided. Infection. Infection of the skin is exceedingly rare. However, it is a possible risk following a skin burn or wound caused by the use of the device.

Bruising. Very rarely, the use of the device could cause blue-purple bruising that may last 5 to 10 days. As the bruising fades , there may be a rust-brown discoloration of the skin (hyperpigmentation).

2. PARTS AND COMPONENTS

- Fig. 1.
- 1. On/off/intensity level button
 - 2. Intensity level light indicator
 - 3. Ready/skin colour warning light indicator
 - 4. Socket
 - 5. Skin contact surface
 - 6. Flash light window
 - 7. Flash button
 - 8. Adapter
 - 9. Small plug of AC adapter cord

3. BEFORE USE

Take the product out of the box.

Remove all packaging materials and labels before plugging the device. Keep the original box. Make sure all parts and components are included and in good conditions. If any visible signs of damage are observed, contact Cecotec's Technical Support Service immediately.

4. OPERATION

This appliance is intended for the removal of unwanted hair. It is able to deliver long-term reduction in the number of hairs that regrow after treatment.

- Notes:
- 1. Choose the intensity power level according to you skin tone. The intensity lights around the intensity button indicate the intensity level at which the device is set. As the intensity level increases, so do the results as well as the risk of side effects.
 - 2. Always start using the device at the lowest intensity level. Only if you experience little or no discomfort during and after use at the lowest intensity level, raise the intensity by one

- level the next time.
- 3. Avoid adverse effects.
Do not use on the same skin area more than once during a session.
Avoid overlapping flashes.
If your skin blisters or burns, stop using the device immediately.
- 4. Avoid complications after use.
 - a. Do not expose the treated areas to the sun. Sun exposure includes constant unprotected exposure to direct sunlight for over 15 minutes, or unprotected exposure to diffuse sunlight for 1 hour. Apply screen with SPF 30 or higher thoroughly for 2 weeks after each hair removal session.
 - b. Cover birthmarks and tattoos before use. Cover dark brown or black spots, such as large freckles, birthmarks, moles or warts before use.

Suitable body hair colours

Fig. 2.

Use and effectiveness

Skin type	Hair colour	Light intensity	Body part	Use	Effectiveness (% of hair removal/ regrowth)
I-IV	Light brown to brown	Max. 4	Lower or upper legs	Session 10-12 approx., 4 weeks apart	60 % hair reduction
			Arms		55 % hair reduction
			Bikini line		60 % hair reduction
			Underarms		50 % hair reduction

Skin type	Hair colour	Light intensity	Body part	Use	Effectiveness (% of hair removal/regrowth)
I-IV	Brown-black	Max. 4	Lower or upper legs	Session 8-10 approx., 4 weeks apart	70 % hair reduction
			Arms		60 % hair reduction
			Bikini line		70 % hair reduction
			Underarms		65 % hair reduction

Note: Individual response depends on hair type as well as biological factors that may affect hair growth patterns. Some users may respond quicker or slower than the average number of use. Do not expect permanent hair reduction in one or two sessions. The duration of the resting period for hair follicles also depends on the body area.

Preparing for use

Pre-treating the skin

Remove hairs on the surface of your skin. This allows the light to be absorbed by the hair parts below the skin surface to ensure effective use. You can either shave, short-trim, epilate or wax. Do not use depilatory creams, as chemicals may cause skin reactions.

CLEAN YOUR SKIN AND MAKE SURE IT IS HAIR-FREE, ENTIRELY DRY AND FREE FROM OIL SUBSTANCES.

Note: If shaving causes skin irritation, do not use the device until irritation has disappeared.

Skin test

Before your first treatment, perform a skin test to establish the appropriate intensity level for each body part.

1. Choose an area close to the area where you want to use the device.

Note: Do not try the device on difficult or sensitive areas (ankle and bony area).

2. Turn on the device and set the desired intensity level.
3. Place the device at a 90° angle on the skin so that the integrated safety system is in contact with your skin.

Note: The integrated safety system prevents unintentional flashing without skin contact.

4. Press the flash button to release a flash.
5. Move the appliance to another area and release a flash at level 2. Continue to increase the intensity by one level before releasing each next flash. Do not release more than one flash in the same spot. Do not increase the intensity beyond the maximum intensity for

your skin colour.

6. As soon as you experience any discomfort, reduce the intensity level to the highest level at which there was no discomfort.
7. Stop testing. Wait for 24 hours and then check your skin for any reactions. If you see no skin reactions, you can use the intensity level last used at your next treatment of this body part.

Note: If your skin shows a reaction, wait for the reaction to disappear. Then treat the body part at the intensity level below the one that produced a reaction, wait for 24 hours and check for skin reactions again.

8. Repeat these steps on all body parts you intend to treat.

Using Bamba SkinCare IPL Quartz

Skin tone sensor

The product has skin colour identification function.

When the device is turned on, the flashlight window must be put in full contact with the skin.

The light indicator will flash 5 times indicating that the device is recognising the skin tone.

According to your skin tone, the device will recommend the intensity suitable for you.

Press the on/off/intensity level button once to confirm the recommended intensity level, and twice to start the device.

When the skin recognition function is selected and the sensor detects too dark skin tone (including dark brown), the skin colour warning indicator will turn orange and will flash.

This indicates that the skin tone sensor could not recognise the skin colour and the device will not operate.

Selecting the right intensity

The intensity of the flash that reaches your skin is adjusted with the On/off/intensity level button.

There are 5 intensity levels. The corresponding intensity light bar will illuminate when an intensity level is selected.

Always use the lowest setting at first and increase carefully.

Press the On/off/intensity level button to select the desired intensity level. After 1 cycle (1-5) it returns to level 1.

Skin type/skin tone

Skin type	Skin tone	Intensity level
I	White	4-5
II	Beige	3-4
III	Light brown	2-3
IV	Mid-brown	1-2
V	Dark brown	Do not use the device
VII	Brownish black or darker	Do not use the device

Note: Your skin may react differently on different days/occasions for a number of reasons.

Manual operation method

Plug the device into a power supply. Wait until the ready light indicator turns on red.

Press the On/off/intensity button. The light of intensity level 1 will turn on and the fan inside the appliance starts.

After about 1 second, the Ready/skin colour warning light comes on. This shows that the appliance is ready to release a flash.

Press the On/off/intensity button one or more times to choose the intensity level suitable for the treatment area and your skin colour.

Make sure that the treatment area is clean, dry and properly shaved. Place the skin contact surface on the skin at a 90° angle.

Press the flash button.

Automatic skin tone detection

Plug the device into a power supply. Wait until the ready light indicator turns on red.

Press the On/off/intensity button. The light of intensity level 1 will turn on and the fan inside the appliance starts.

Place the skin contact surface on the skin at a 90° angle. The integrated safety system will prevent unintentional flashing without skin contact. The light indicator will turn on green.

Press the flash button. The device will select an appropriate intensity level for the user according to the skin tone. The corresponding intensity light indicator will turn on.

Note: It is very important to keep the flash light window tightly closed to the skin in order for the sensor to be able to detect the skin tone. Since different parts of the skin can have different tones, repeat the last step every time you change zone.

While the fan is running, hold the flash light window tightly close to the skin and press the flash button. The light indicator will turn green and blink.

Press the flash button to start removing hair.

Release flashes one next to another to ensure that hair is removed from the whole area.

Make sure not to release more than 1 flash on the same area.

Note:

Do not use any pencil or pen to mark the areas, as this may cause side effects to your skin.

Flashing the same area does not improve the effectiveness of the use but increase the risk of skin reactions.

When you have finished using the device, hold down the On/off button for 2 seconds to switch it off.

Flashing methods

Manual flash

Ideal to use on small or curvy areas like knees and underarms. Simply press and release the flash button to release a single flash.

Sliding flash

Ideal to use on large areas like legs. Keep the flash button pressed while you slide the device over your skin to release several flasher in a row.

Note: If the cooling fan stops rotating, stop using the device immediately, otherwise it may lead to flash rupture due to high temperature and damage the skin.

After hair removal treatment

When you have completed your hair removal cycle, press and hold the intensity button to turn off the device.

Be sure to remember the last intensity level setting used, as the device is automatically reset to the lowest setting when turned off, and it does not remember the previously selected setting.

Unplug the device from the power supply.

Skin care after hair removal session

Do not expose the treated skin to the sun. If it is going to be exposed, thoroughly apply SPF 30 or higher sunscreen for 2 weeks after each hair removal.

Side effects and complications

Some users may experience pigmentation changes as a result of treatment with the IPL hair removal device. These effects, if they occur, are generally mild and temporary. If you experience any complication, please contact your physician immediately.

5. CLEANING AND MAINTENANCE

Unplug the device from the power supply before cleaning it.

Clean the device after each use, especially the skin contact surface.

After cleaning, store it in its original box and keep it away from water.

Use a dry, clean cloth and a specially formulated cleaner for electronic equipment to gently wipe the outer shell and the skin contact surface of the device.

Never immerse the device or any of its parts in water.

6. TROUBLESHOOTING

My Bamba SkinCare IPL Quartz does not turn on.

Make sure that the power cord is plugged into the device socket properly.

Make sure that the adapter is plugged into power supply properly.

No flash is emitted when the flash button is pressed

Make sure that the green ready light is blinking.

Make sure that the device is in full contact with the skin. For your safety, the flash button will only activate a flash if the skin contact surface is in full contact with the skin.

Check if the skin colour warning light blinks orange. If it does, the skin colour sensor has stopped the emission of the flash. Your skin may be too dark for using the appliance.

Try using the device on a different part of your body.

If the ready light is on constantly together with any other lights, there is a system error. Turn off the device and unplug it. Then, plug in the device and try to turn it on again. If the problem persists, contact the Technical Support Service of Cecotec.

Check if the system warning light is on and all other lights are blinking. If so, unplug the device. The device has reached the end of its life. Contact the Technical Support Service of Cecotec.

7. TECHNICAL SPECIFICATIONS

Product: Bamba SkinCare IPL Quartz

Product reference: 04245

Technology: Intense pulsed light

Flash duration: 500-800 usec

Wave length: 475-1200 nm

Power output: Max. 4j/cm²

100-240 V; 50-60 hZ; 0.5 A

8. DISPOSAL OF OLD ELECTRICAL APPLIANCES



The European directive 2012/19/EU on Waste Electrical and Electronic Equipment (WEEE), specifies that old household electrical appliances must not be disposed of with the normal unsorted municipal waste. Old appliances must be collected separately, in order to optimize the recovery and recycling of the materials they contain and reduce the impact on human health and the environment.

The crossed out "wheeled bin" symbol on the product reminds you of your obligation to dispose of the appliance correctly. If the product has a built-in battery or uses batteries, they should be removed from the appliance and disposed of appropriately.

Consumers must contact their local authorities or retailer for information concerning the correct disposal of old appliances and/or their batteries.

9. TECHNICAL SUPPORT AND WARRANTY

This product is under warranty for 2 years from the date of purchase, as long as the proof of purchase is submitted, the product is in perfect physical condition, and it has been given proper use, as explained in this instruction manual.

The warranty will not cover the following situations:

The product has been used for purposes other than those intended for it, misused, beaten, exposed to moisture, immersed in liquid or corrosive substances, as well as any other fault attributable to the customer.

The product has been disassembled, modified, or repaired by persons, not authorised by the official Technical Support Service of Cecotec.

Faults deriving from the normal wear and tear of its parts, due to use.

The warranty service covers every manufacturing defects of your appliance for 2 years, based on current legislation, except consumable parts. In the event of misuse, the warranty will not apply.

If at any moment you detect any problem with your product or have any doubt, do not hesitate to contact Cecotec Technical Support Service at +34 963 210 728.

www.cecotec.es

Grupo Cecotec Innovaciones S.L.
C/ de la Pinadeta s/n, 46930
Quart de Poblet, Valencia (Spain)
IC01200824