

cecotec

BAMBA PRECISIONCARE ALLDRIVE PRO

Barbero con dial/Beard and hair trimmer with precision dial

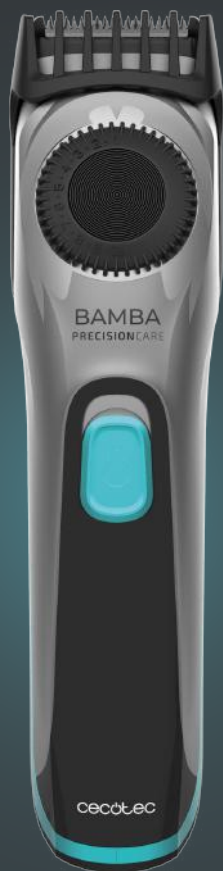

BAMBA

Manual de instrucciones
Instruction manual
Manuel d'instructions
Bedienungsanleitung
Manuale di istruzioni
Manual de instruções
Instructiehandleiding
Instrukcja obsługi
Návod k použití

INDEX

1. Parts and components	41
2. Before use	41
3. Operation	42
4. Cleaning and maintenance	43
5. Technical specifications	43
6. Disposal of old electrical and electronic appliances	44
7. Technical support and warranty	44
8. Copyright	44

SAFETY INSTRUCTIONS

Read these instructions thoroughly before using the product. Keep this instruction manual for future reference or new users.

- Ensure that the mains voltage matches the voltage specified on the product rating label and that the plug is earthed.
- The appliance must be powered at a low safety voltage as stated on the product marking.
- This appliance is designed for domestic use only and is not intended for bars, restaurants, farmhouses, hotels, motels, and offices.
- **WARNING:** keep the appliance dry.
- **PRECAUTION:** do not use this appliance near bathtubs, showers, sinks, or other water containers.
- Do not immerse the cord, plug, or any non-removable part of the appliance in water or any other liquid, nor expose electrical connections to water. Make sure your hands are

- dry before handling the plug or switching on the appliance.
- Do not use the device if its cord or any other part is damaged. In this case, contact the official Cecotec Technical Support Service.
 - Keep all packaging materials away from children. Risk of suffocation.
 - This device must be checked frequently for signs of wear or damage. If such signs are present, or if the device has been used improperly, contact the official Cecotec Technical Support Service. Do not try to repair the device by yourself.
 - Switch off the device immediately in the event of defects or malfunctions. Pull from the plug, not the cord, to disconnect it from the outlet.
 - Do not use accessories or parts that have not been provided by Cecotec
 - Never leave the appliance unattended while in use.
 - Check the power cord regularly for visible damage. If the power cord is damaged, it must be replaced with a special cord or set to be supplied by the official Cecotec Technical Support Service or the corresponding after-sales service to avoid any danger.
 - Keep the device away from heat sources.
 - Do not use an extension cord with this appliance.
 - Do not use outdoors or operate it near flammable substances such as sprays.
 - Do not place the device directly on any non-heatproof surfaces while plugged in and in operation.
 - Do not try to open, disassemble, or repair the product by yourself. There are no serviceable parts inside the device.
 - The device is exclusively designed for trimming natural hair. Do not use it with artificial or animal hair.
 - Cecotec accepts no liability for damage caused by improper

or incorrect use.

- Do not operate the device near water or in places where it could get wet.
- Do not use the device if your skin or head skin is injured or suffers from any type of illness.
- Turn off and unplug the device from the power supply before assembling or disassembling attachments.
- WARNING: to recharge the battery, use only the detachable power supply provided with the appliance: KH6-050100EU.
- The appliance can be used by children from 3 years old under supervision.
- The appliance can be used by children aged 8 years and above and persons with reduced physical, sensory, or mental capabilities or lack of experience and knowledge if they have been given supervision or instruction concerning the safe use of the appliance and understand the hazards involved. Children must not play with the appliance. Cleaning and user maintenance should not be carried out by unsupervised children.

Battery instructions

- This appliance contains an irreplaceable battery.
- This appliance includes a Li-ion battery. Do not incinerate or expose it to high temperatures, as it may explode.
- Leaks from the battery or battery cells can occur under extreme conditions. Do not touch any liquid that leaks from the battery. If the liquid gets into contact with skin, wash immediately with soap and water. If the liquid gets into the eyes, wash them immediately with clean water for a minimum of 10 minutes and seek medical attention. Wear gloves to handle the battery and dispose of immediately in accordance with local regulations.

- Avoid contact between the battery and small metallic objects such as paper clips, coins, keys, nails, or screws.
- Before a new battery is used or the battery is used for the first time after long-term storage, fully charge the battery.
- When the device is stored and not used for long periods of time, ensure that the battery pack is fully charged.
- Keep batteries out of the reach of children when there is a risk of ingestion.
- Battery ingestion can cause burns, soft tissue perforation, and death. It can cause severe burns within two hours of the ingestion.
- In case of battery ingestion, please seek medical help immediately.

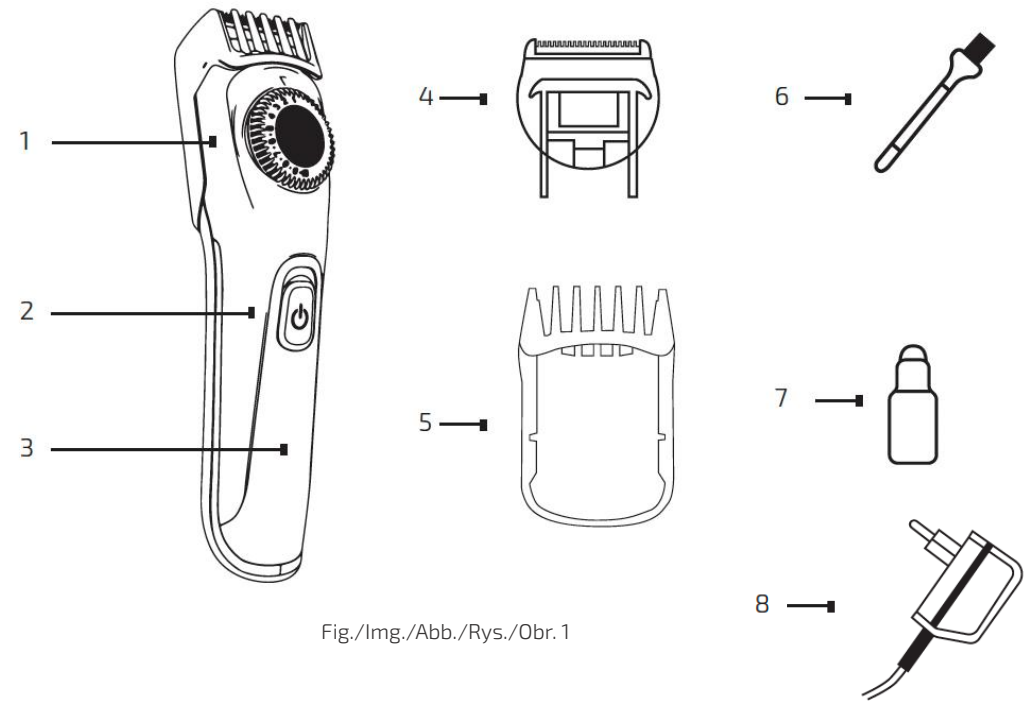

Fig./Img./Abb./Rys./Obr. 1

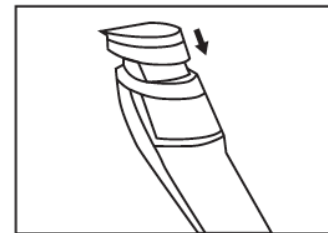

Fig./Img./Abb./Rys./Obr. 2

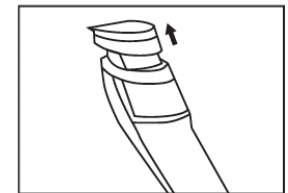

Fig./Img./Abb./Rys./Obr. 3

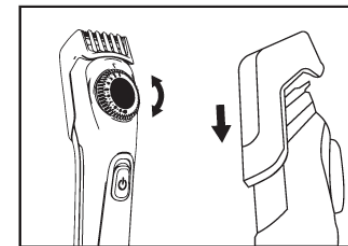

Fig./Img./Abb./Rys./Obr. 4

1. PARTS AND COMPONENTS

Fig. 1.

1. Precision dial
2. Power switch
3. Charge indicator
4. Blade head
5. Guide comb (1-10 mm)
6. Cleaning brush
7. Lubricating oil
8. Power cord

NOTE:

The graphics in this manual are schematic representations and may not exactly match the product.

2. BEFORE USE

- This appliance is packaged in a way as to protect it during transport. Take the appliance out of its box and remove all packaging materials. You can keep the original box and other packaging elements in a safe place. This will help you prevent product damage when transporting it in the future. In case the original packaging is disposed of, make sure all packaging materials are recycled accordingly.
- Make sure all parts and components are included and in good conditions. If there is any piece missing or in bad conditions, contact the official Cecotec Technical Support Service immediately.

Box contents

- Bamba PrecisionCare AllDrive Pro
- Guide comb (1-10 mm)
- Lubricating oil
- Cleaning brush
- Adapter
- Instruction manual

- Fully charge the device before first use.
- Oil the device blades before first use.

Warning

Turn the device off before replacing or assembling any attachment.

3. OPERATION

Installing the blade head

1. Make sure that the device is turned OFF before installing or handling the blade head.
2. Align both sides of the of the blade head with the slots on the main body of the device.
3. Insert the head into the main body of the device as shown below.

Fig. 2.

Removing the blade head

1. Make sure that the device is turned OFF before installing or handling the blade head.
2. Hold the device firmly and press upwards against the white arrow of the blade head.
3. Carefully remove the blade head from the main body.

Fig. 3.

Attaching the guide comb

1. Make sure that the device is turned OFF before attaching the guide comb (5).
2. Align the precision dial (1) with indicator "10".
3. Mount the guide comb to the main body as shown in Figure 4.
4. Adjust the length of the cut by turning the precision dial (1).

Fig. 4.

Please note

The length of the cut may vary depending on the trimming angle. Start using the precision dial at a higher setting and decrease it as you cut the hair.

Operating instructions

1. Slide the power switch to the OFF position to turn OFF the device.
2. Attach the guide comb and choose the desired precision-dial setting.
3. Slide the power switch to the "ON" position to turn ON the device.
4. Trim against the hair by guiding the flat part of the guide comb over the skin.
5. Prevent the device from clogging by cleaning and removing excess hair periodically.

Please note

The precision dial will not turn when the device is switched on.

4. CLEANING AND MAINTENANCE

- Turn off and disconnect the device from the mains supply before cleaning, servicing it, or assembling or disassembling any of its parts.
- To clean the blade head, disassemble it and use the brush to remove hair from the device's blade head and main body.
- Detach the guide comb and the head and clean them in water. Do not use hot water.
- Do not use compressed air, abrasive cleaners, or scouring pads to clean the product.
- Do not immerse the device body in water or any other liquid or place it under running water.
- The blade head is waterproof and can be washed if necessary. Dry it carefully before storing or reattaching it on the device.
- Clean the device and the attachments after each use with the cleaning brush.
- Regularly check that the device is in good condition, paying particular attention to moving parts.

Warning

The body of the device is not washable. Do not submerge in water.

Oiling the head blades

- Rinsing the head under water requires lubricating the cutting blades at least once per month.
- Use only light-grade oils, as these will not evaporate nor slow down the speed of the cutting blades.
- Do not use hair oil, grease, or any oil mixed with kerosene nor solvent, as these too will evaporate quickly.

5. TECHNICAL SPECIFICATIONS

Product name: Bamba PrecisionCare AllDrive Pro

Product reference: 04401

Charger: Input 100-240 V~, 50/60 Hz, 0.2A Max

Output: 5 V , 1000 mA

Beard trimmer: Input: 5 V , 1000 mA

Battery: 3.7 V, 600 mAh, 2.22 Wh

Technical specifications may change without prior notification to improve product quality.

Made in China | Designed in Spain

6. DISPOSAL OF OLD ELECTRICAL AND ELECTRONIC APPLIANCES



This symbol indicates that, according to the applicable regulations, the product and/or batteries must be disposed of separately from household waste. When this product reaches the end of its shelf life, you should dispose of the cells/batteries/accumulators and take them to a collection point designated by the local authorities.



For detailed information on the most appropriate way to dispose of electrical and electronic equipment and/or batteries, consumers should contact their local authorities.

Compliance with the above guidelines will help protecting the environment.

7. TECHNICAL SUPPORT AND WARRANTY

Cecotec shall be liable to the end user or consumer for any lack of conformity that exists at the time of delivery of the product under the terms, conditions, and deadlines established by the applicable regulations.

It is recommended that repairs be carried out by qualified personnel.

If at any moment you detect any problem with your product or have any doubt, do not hesitate to contact the official Cecotec Technical Support Service at +34 963 210 728.

8. COPYRIGHT

The intellectual property rights over the texts in this manual belong to CECOTEC INNOVACIONES, S.L. All rights reserved. The contents of this publication may not, in whole or in part, be reproduced, stored in a retrieval system, transmitted, or distributed by any means (electronic, mechanical, photocopying, recording or similar) without the prior authorization of CECOTEC INNOVACIONES, S.L.

Information requirement for external power supplies			
Information published	Value and precision	Unit	Notes
Manufacturer's name or trademark, commercial registration number and address	Ningbo KAM HOY Electronic Appliance Co., Ltd. Sanfengqiao, Lan Jiang Street, Yu Yao City, Zhejiang, China	--	--

Name of the model	KH6-050100EU	--	--
Input voltage	100-240	V	Specified by the manufacturer. Must be a value or a range..
Input AC frequency	50/60	Hz	Specified by the manufacturer. Must be a value or a range.
Output voltage	5.0	V	Nameplate output voltage. Shall indicate whether is AC or DC. In cases where more than one physical output or more than one output voltage at load condition 1 are measured, the sets of available Output voltage — Output intensity – Output power will be published.
Output current	1.0	A	Output power In cases where more than one physical output or more than one output voltage at load condition 1 are measured, the sets of available Output voltage — Output intensity – Output power will be published.
Output power	5.0	W	Rated output power. In cases where more than one physical output or more than one output voltage at load condition 1 are measured, the sets of available Output voltage — Output intensity – Output power shall be published.

ENGLISH

Average active efficiency	74.47 for 115V/60Hz 74.63 for 230V/50Hz	%	Declared by the manufacturer based on the value calculated as arithmetical mean of efficiency at load conditions 1-4. In cases where multiple average active efficiencies are declared for multiple output voltages available at load condition 1, the value published shall be the average active efficiency declared for the lowest output voltage.
Efficiency at low load (10 %)	--	%	Declared by the manufacturer based on the value calculated in load condition 5. External power supplies with a nameplate output power of 10 W or less shall be exempted from this requirement. In cases where multiple average active efficiencies are declared for multiple output voltages available at load condition 1, the value published shall be the value declared for the lowest output voltage.
No-load power consumption	0.05 for 115V/60Hz 0.06 for 230V/50Hz	W	Declared by the manufacturer based on the value measured for load condition 6.

www.cecotec.es

Cecotec Innovaciones S. L.
C/de la Pinadeta s/n, 46930
Quart de Poblet, Valencia, Spain

EA01221129