

Wire controller Instructions

- Installation should be done by professional personnel.
- For the purpose of easy operation, please read this manual carefully and follow its instructions.
- Please keep the manual carefully for reference.

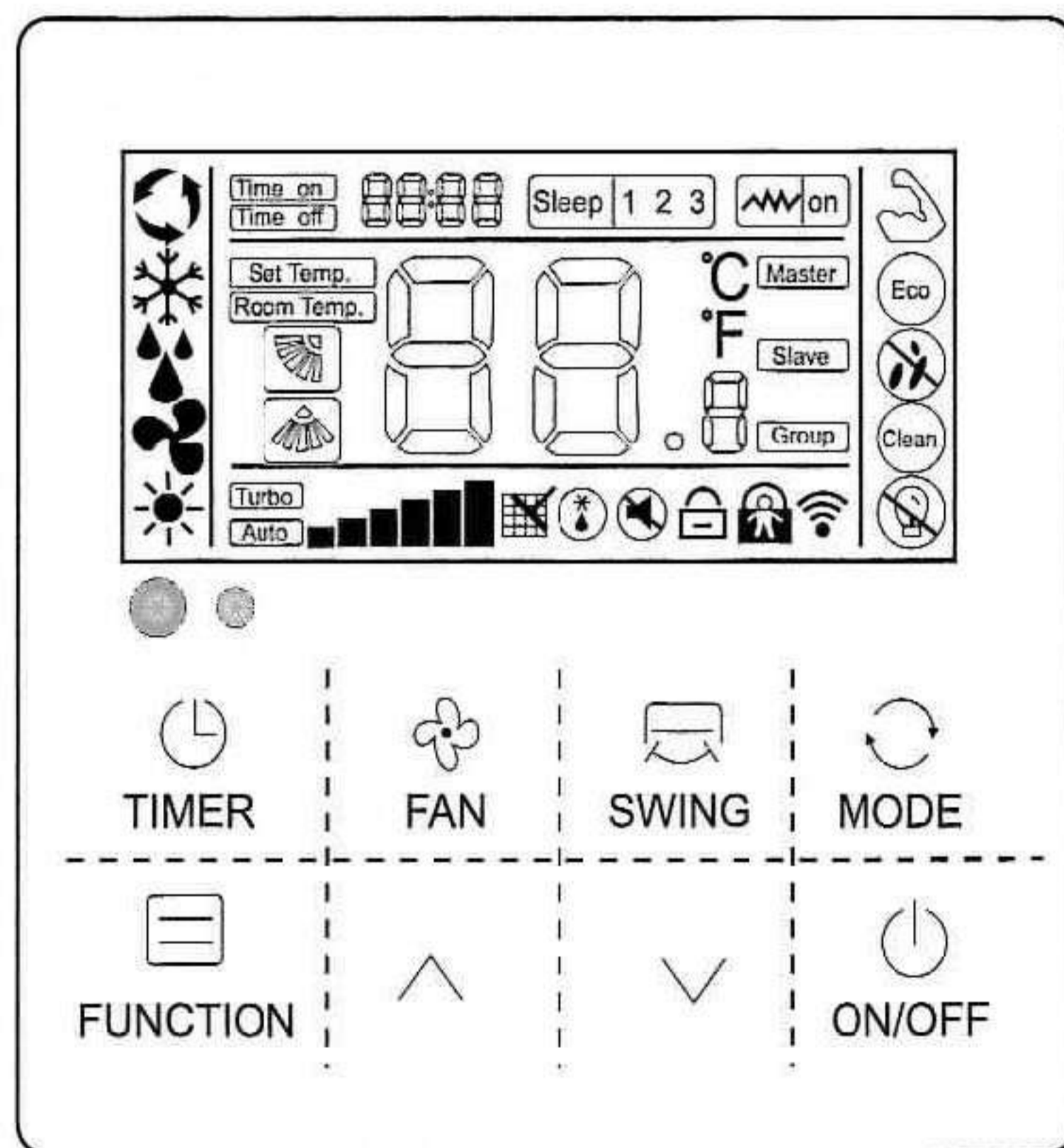

Notice for use

To ensure correct use, please read and follow these notes carefully.

Warning	There is a great possibility of serious accidents such as death, serious injury, fire or property damage caused by ignoring the contents of the warning.
Note	There is a great possibility that the optimum operation result cannot be obtained due to ignoring the contents of the precautions.

- Please entrust a local dealer or local service network station to arrange professional personnel who have air conditioner installation certificate to carry out the installation, users are strictly prohibited to carry out the installation.
- Before cleaning or maintenance, please cut off power switch; waterwashing is prohibited, which has the risk of electric shock.
- Wet hand operation is prohibited, which has the risk of electric shock.
- Pesticides, disinfectants, and flammable spray materials are prohibited for direct spraying; otherwise, it may cause a fire or the deformation of devices.
- Do not peel off the display panel by hand, which has the risk of electric shock.
- Cleaning: Wipe with a paper towel, before cleaning, please long press ^ v button for locking.

- The wire controller is low-voltage circuit, it is prohibited to directly contact with a high-voltage line or be placed together with a high-voltage line in the same wiring pipe, and interval shall be 500mm at least or more.

Technical indicators

- Power voltage range: DC 12V;
- Working ambient humidity: 0 °C~50 °C;
- Humidity: RH20%~RH90%; • Button: Touch button;
- Dimensions(W*H*D):120*120*20mm;

Main functions

- 8-key touch button input;
- LCD+ white backlight;
- Ambient temperature detection sensor;
- Receive the signal of wireless remote controller;
- Buzzer prompt tone function;
- Display the failure of main controller;

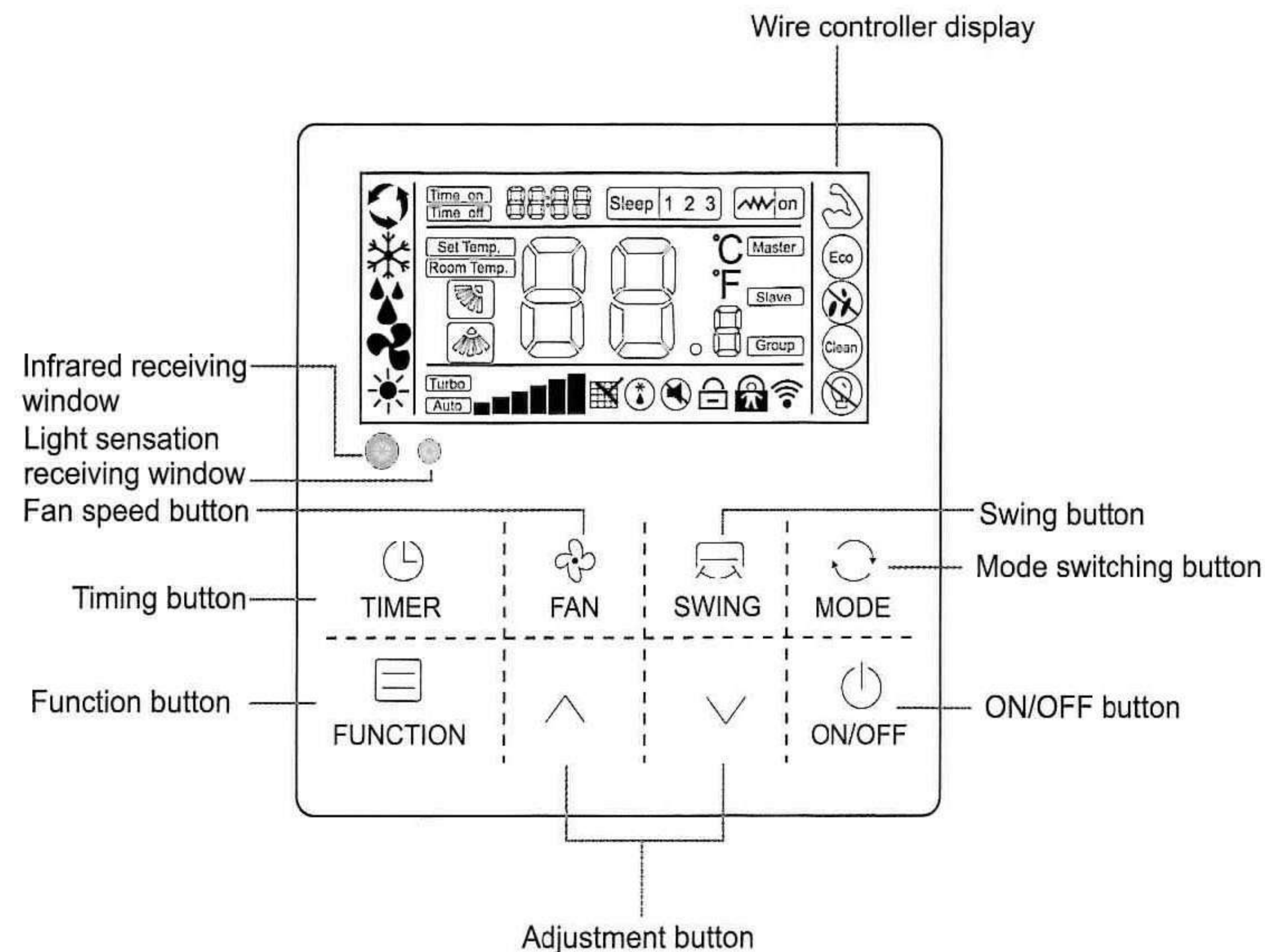

Note: The product adopts touch buttons. To ensure the validity of operation, please touch the center of each icon.

Detailed operation instructions

• ON/OFF button

Press- "ON / OFF" button to start or shutdown the unit.

1. When the unit is running, users can regulate the operation mode, fan speed, setting temperature, special functions and other parameters on the wired controller.

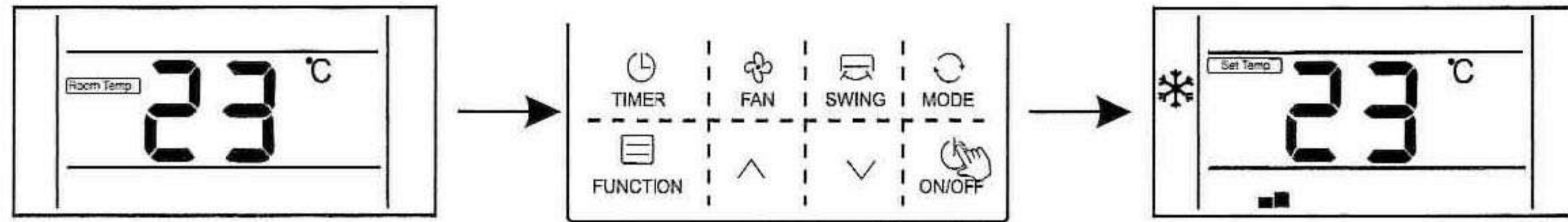

2. When the unit is standby, the wire controller displays indoor ambient temperature (Room temp.), the other content are not displayed.

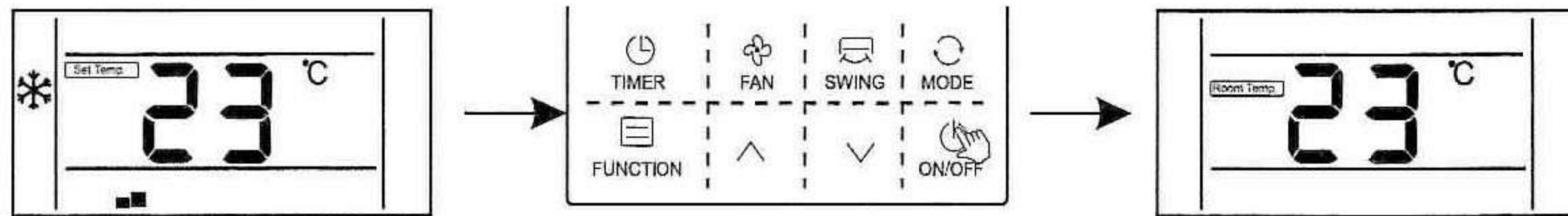

• ^ / v button— Temperature, time setting, function selection.

1. When the unit is running, press " ^ " or " v " button to increase or decrease the setting temperature by 1°C.

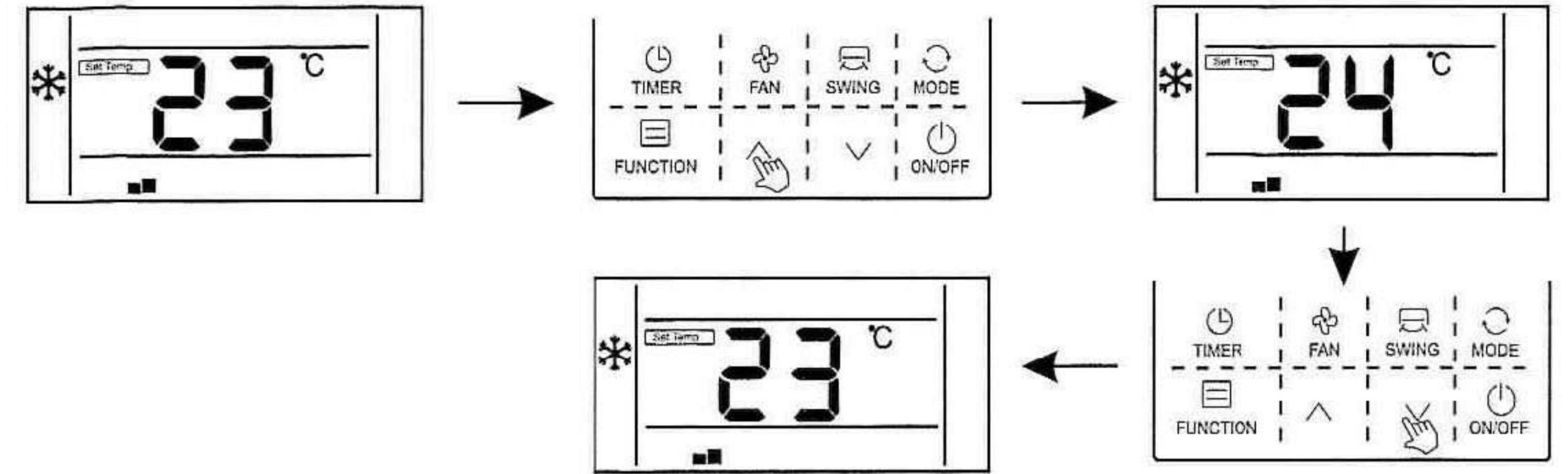

Under COOL, DRY, and HEAT modes, the setting temperature range is 16 °C ~ 32 °C;

The controller will display " Set temp." to show the setting temperature;

2. Under the function selection mode, press " ^ " or " v " button to select a function;

3. Under the timing mode, press " ^ " or " v " button to setting time.

• Mode setting

When the unit is running, press "MODE" button, the running mode will switch according to the following order:

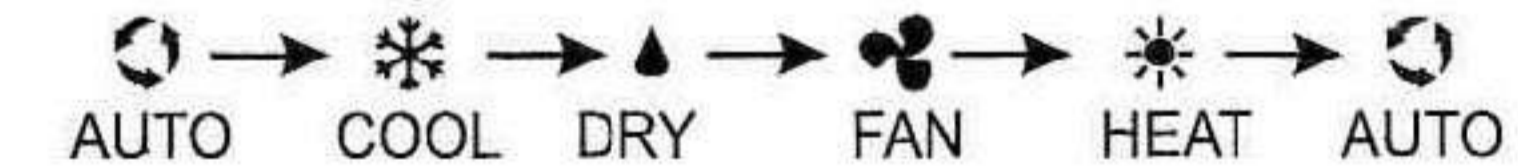

The initial setting temperature for each mode is 24 ° C, and there is no temperature setting and automatic wind under FAN mode.

• The setting of "Wind speed"

When the unit is running, press "Fan" button to switch fan speed in the following order:

3-gear of fan speed (auto and dry mode)

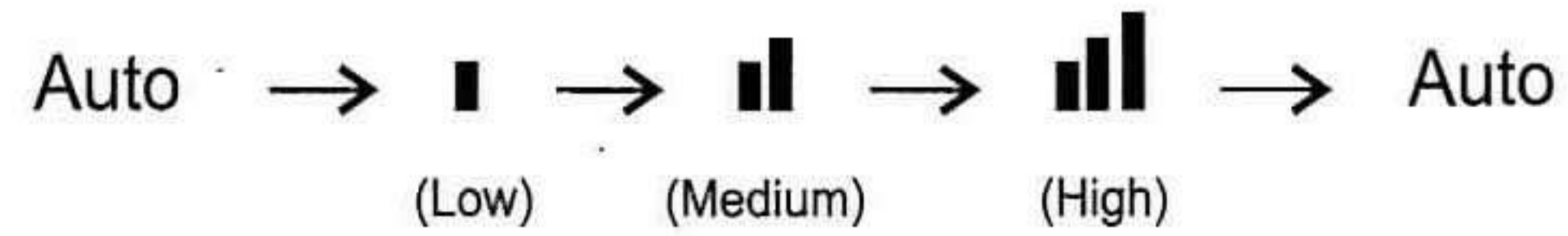

3-gear of fan speed (cool and heat mode)

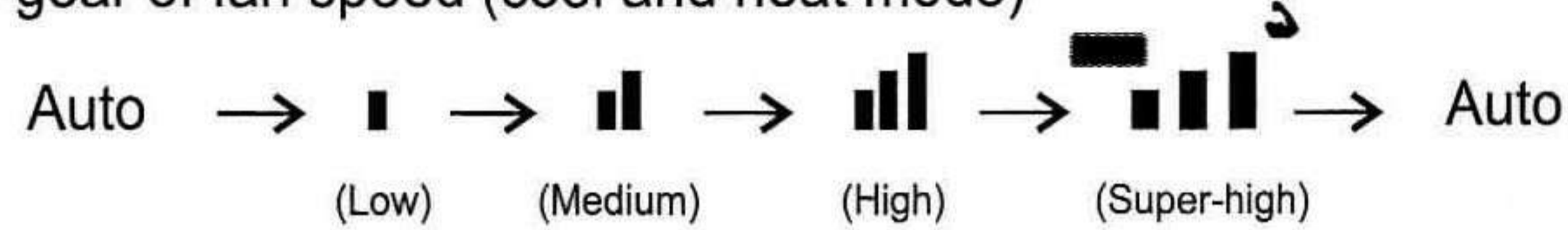

3-gear of fan speed (fan mode)

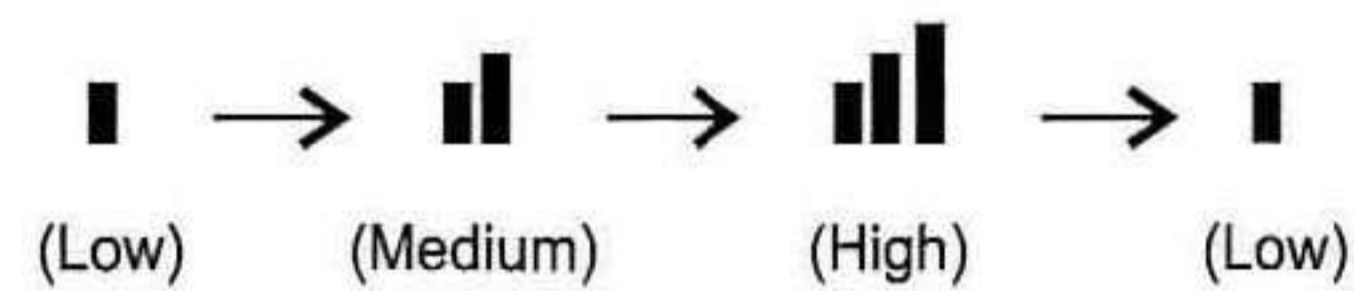

5-gear of fan speed (auto and dry mode)

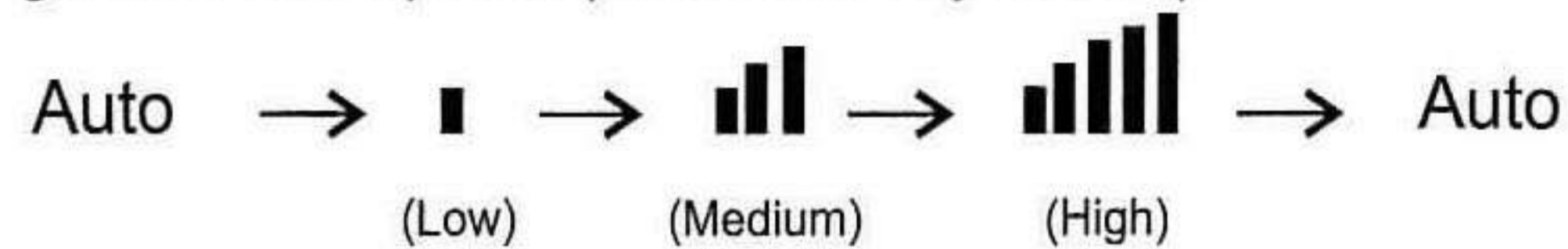

5-gear of fan speed (cool and heat mode)

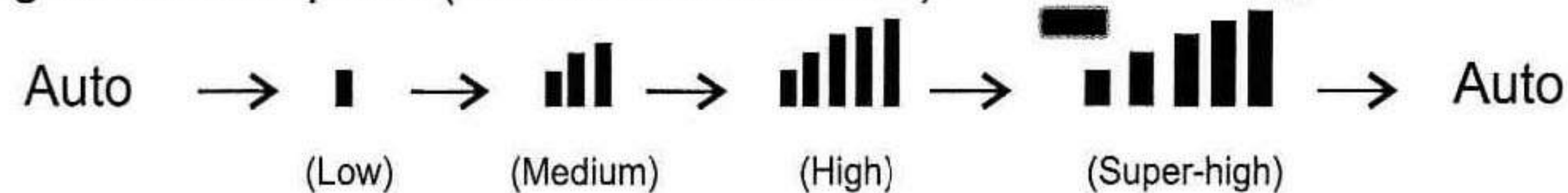

5-gear of fan speed (fan mode)

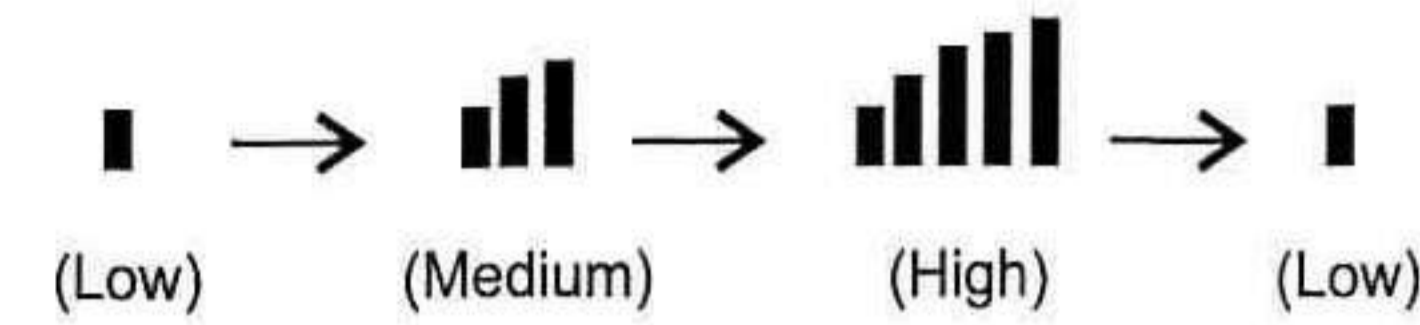

In turbo mode, display fan speed (turbo + highest fan speed icon).

• The setting of "Swing"

1. For the unit only has the function of up and down swing:

when the unit is running, press "Swing" button to enter or cancel up and down swing. At the time of opening up and down swing, "



2. For the unit only has the function of left and right swing:

when the unit is running, press "Swing" button to enter or cancel left and right swing. At the time of opening left and right swing, "



3. For the unit has the functions of left and right swing and up and down swing:
Press "Swing" button, the swing mode will switch in the following cycle order:

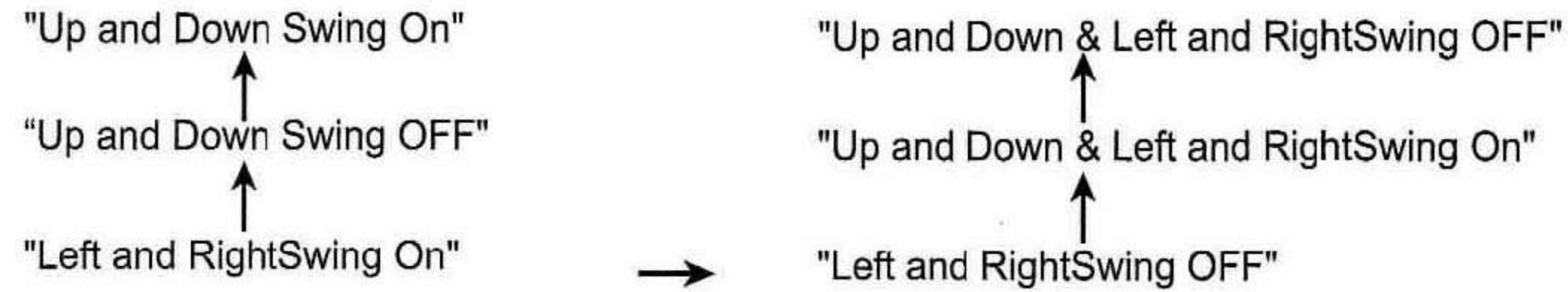

• **"Timing " function**

Users can set shutdown timing time when the unit is running, and set starting-up timing time when the unit is standby.

1. Press "Timer" button when the unit is running, the wired controller will display "Time off" and users can set the shutdown timing time; when the unit is standby, the wired controller will display "Time on", and users can set the starting-up timing time.

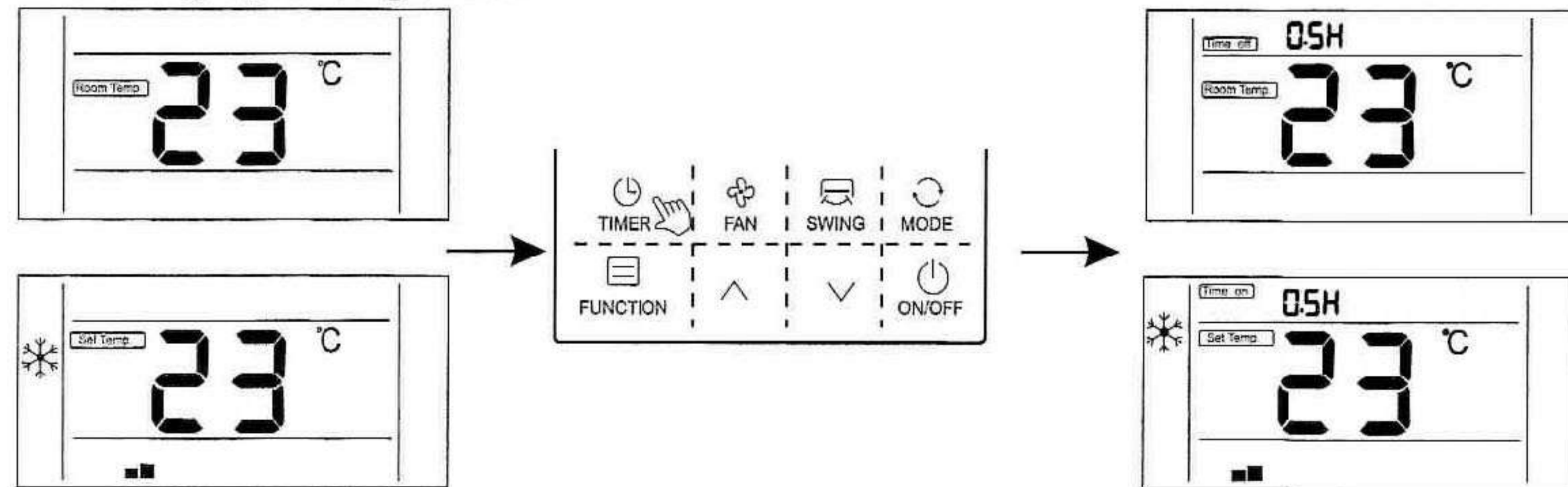

2. After entering timing time setting interface, the default timing time is 0.5H, at this moment, press " ^ " or " v " button to regulate the timing time. If the button is not pressed for 10 seconds, the timing setting will be canceled, and then return to the state of non-timing.

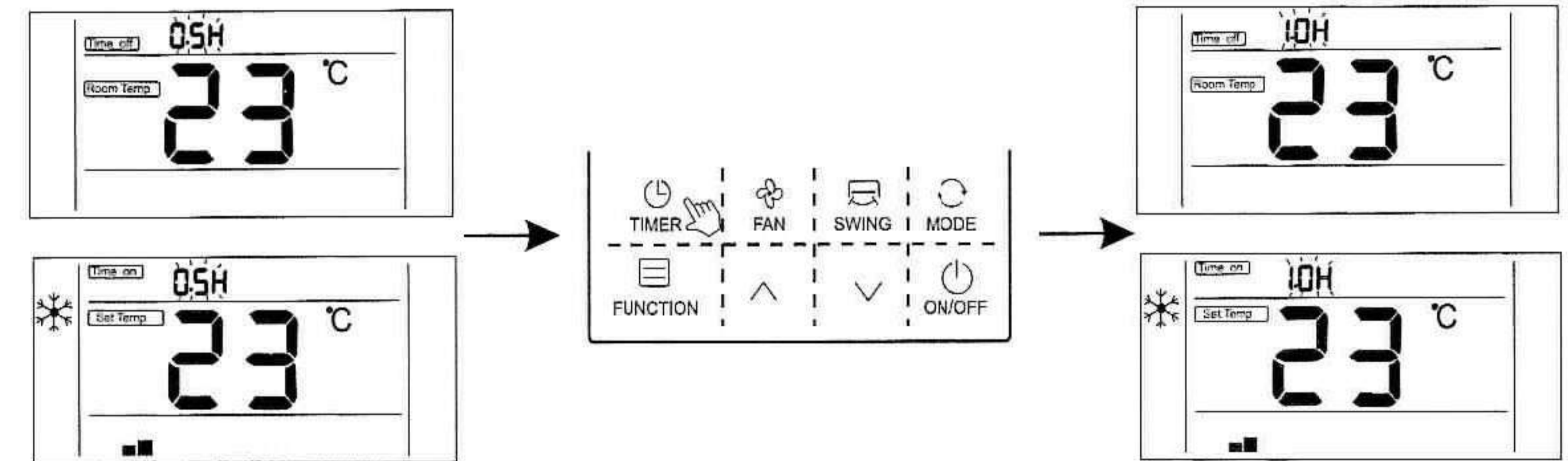

3. After the setting of timing, press "Timer" button again to confirm. The timing setting is successful and the time bar will stop blinking.

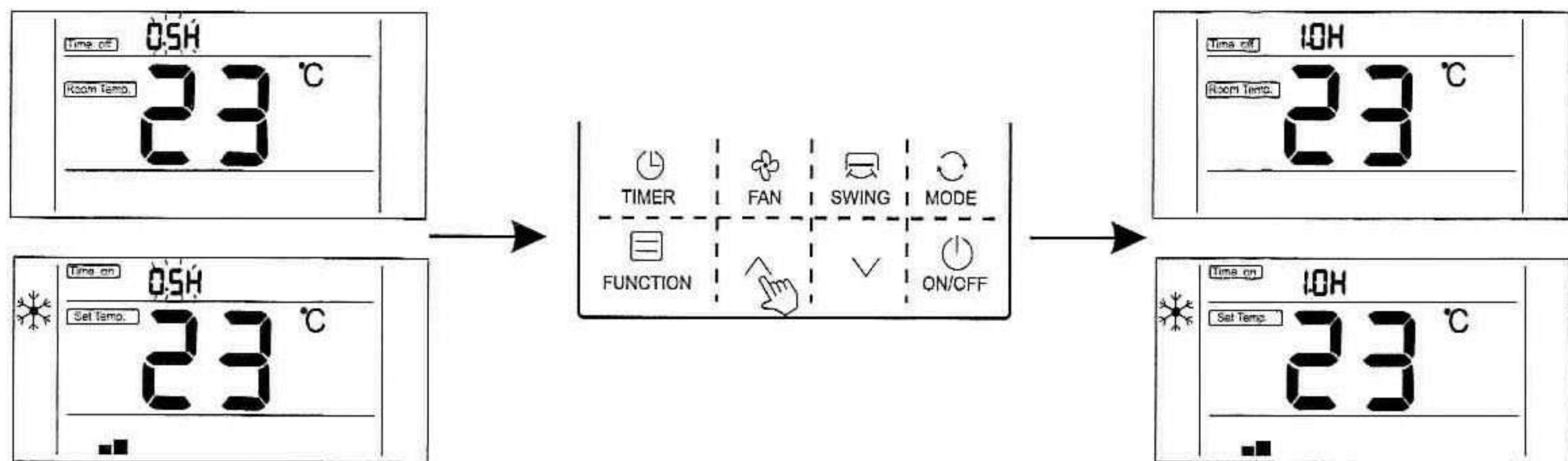

4. After the setting "Timer On" function, you can adjust the fan speed, running mode, set temperature, and swing angle. If there is no operation for 10 seconds, standby screen will be displayed.

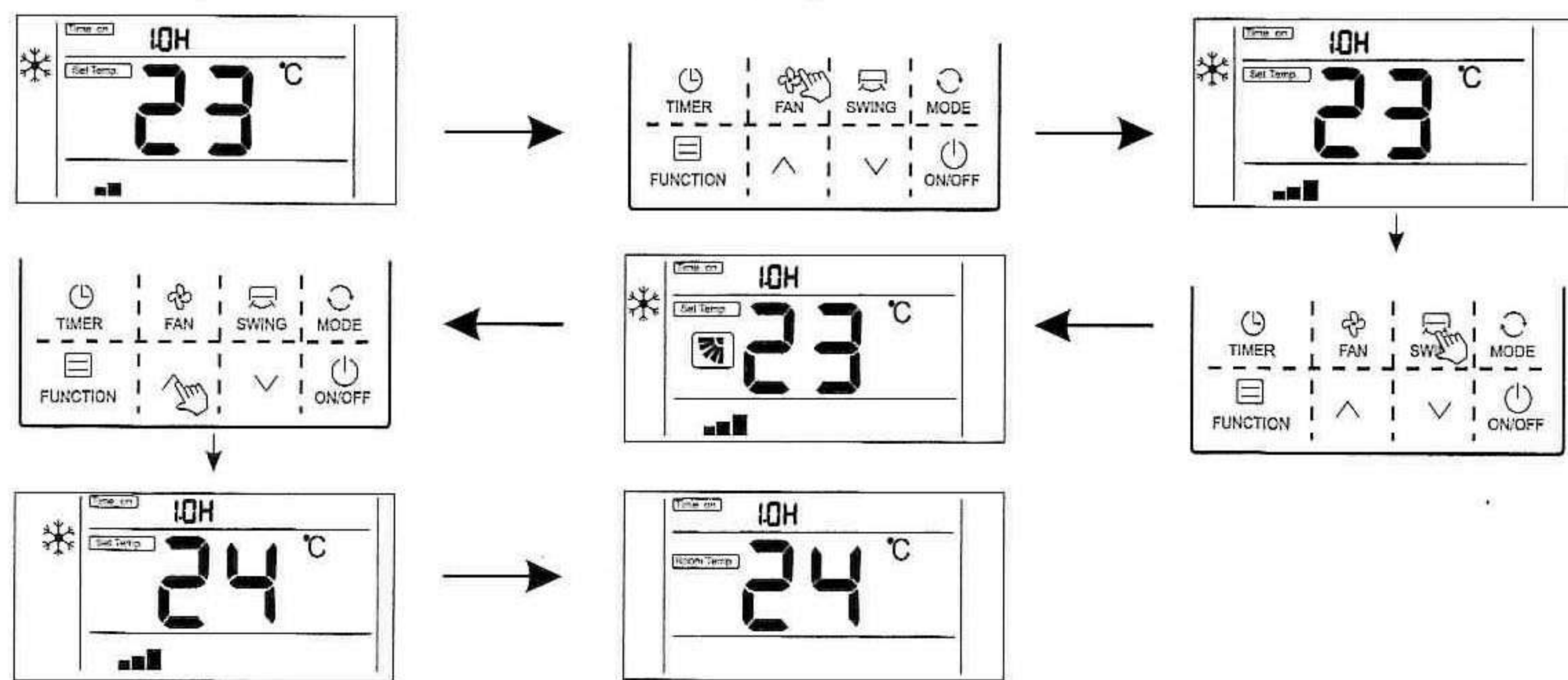

5. Timing range: 0.5~24 hours.

press " ^ " or " v " button once, the timing time will increase or decrease by 0.5 hours. When the timing time is more than 10 hours, press " ^ " or " v " button once, the timing time will increase or decrease by 1 hour.

6. Press "Timer" button or "ON / OFF" button to exit TimerON or TimerOFF.

Function description

The wire controller is for the general-purpose, specific functions for the controller are subject to the functions of your air conditioning unit.

Note: In the interface of function setting, press any button such as Timer, Fan, Swing, Mode, ON/OFF, and Comfort to exit the interface and conventional operation interface will display. If there is no operation for 10S, you can exit the interface.

Enter function: Press function button to enter function selection interface, press " ^ " or " v " to select a function, and the corresponding icon will flash, press "function" button again to confirm the function.

Cancel function: Press function button to enter function selection interface, press " ^ " or " v " to select a function and the corresponding icon will flash, press "function" button again to cancel the function.

• The setting of "Sleep" function

Sleep function: Make indoor unit will run according to pre-set sleep temperature curve, which creates a comfortable sleep environment and improves sleep quality.

Enter sleep function:

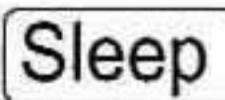
1. In the state of running, press "Function" button to enter the interface of function selection.
2. Press "▲" or "▼" button to switch to sleep function, "Sleep" icon is flashing at this moment
3. Press "Function" button to open sleep function, at this moment, icon  is lighting.

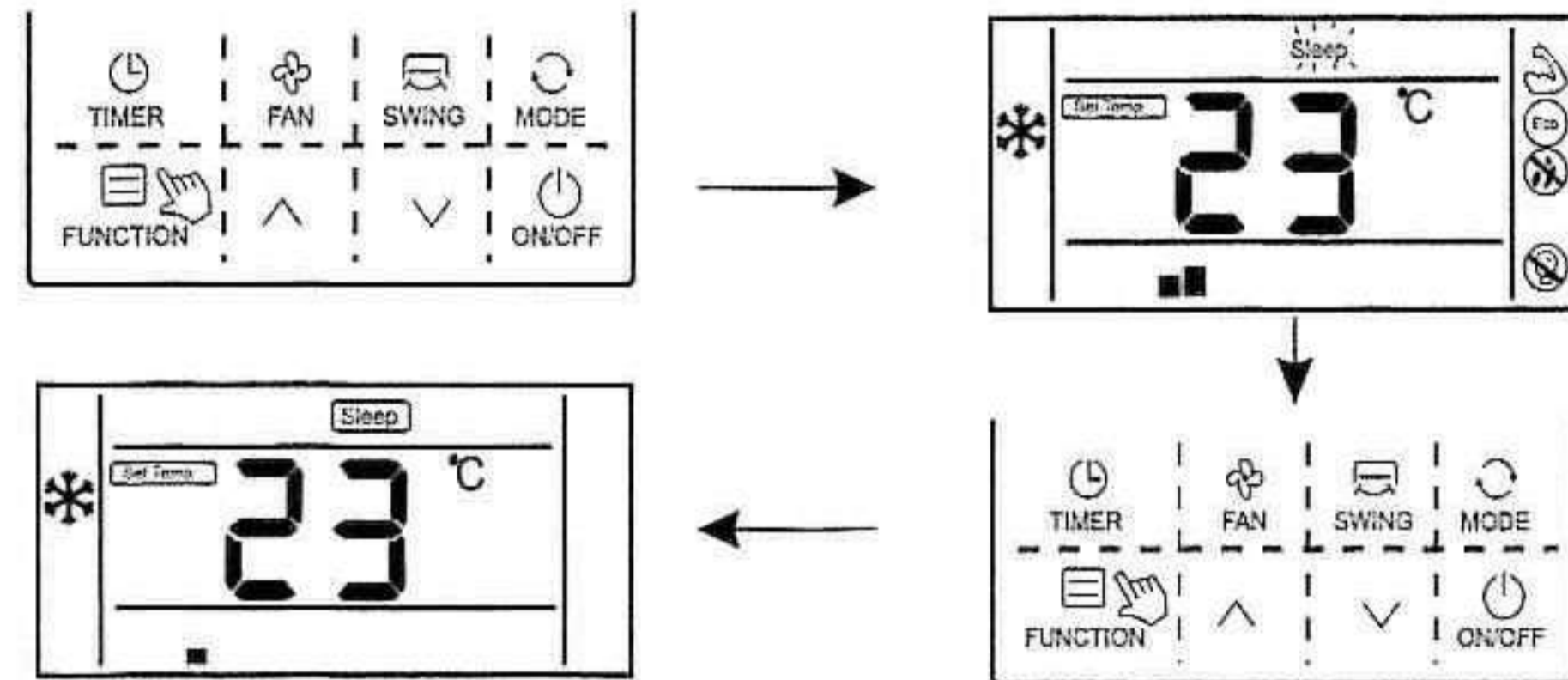

Cancel "sleep" function:

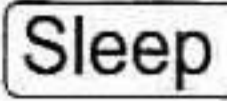
1. When sleep function is opened, press "Function" button to enter the interface of function selection.
2. Press "▲" or "▼" button to switch to sleep function,  icon is flashing.
3. Press "Function" button again to cancel sleep function.

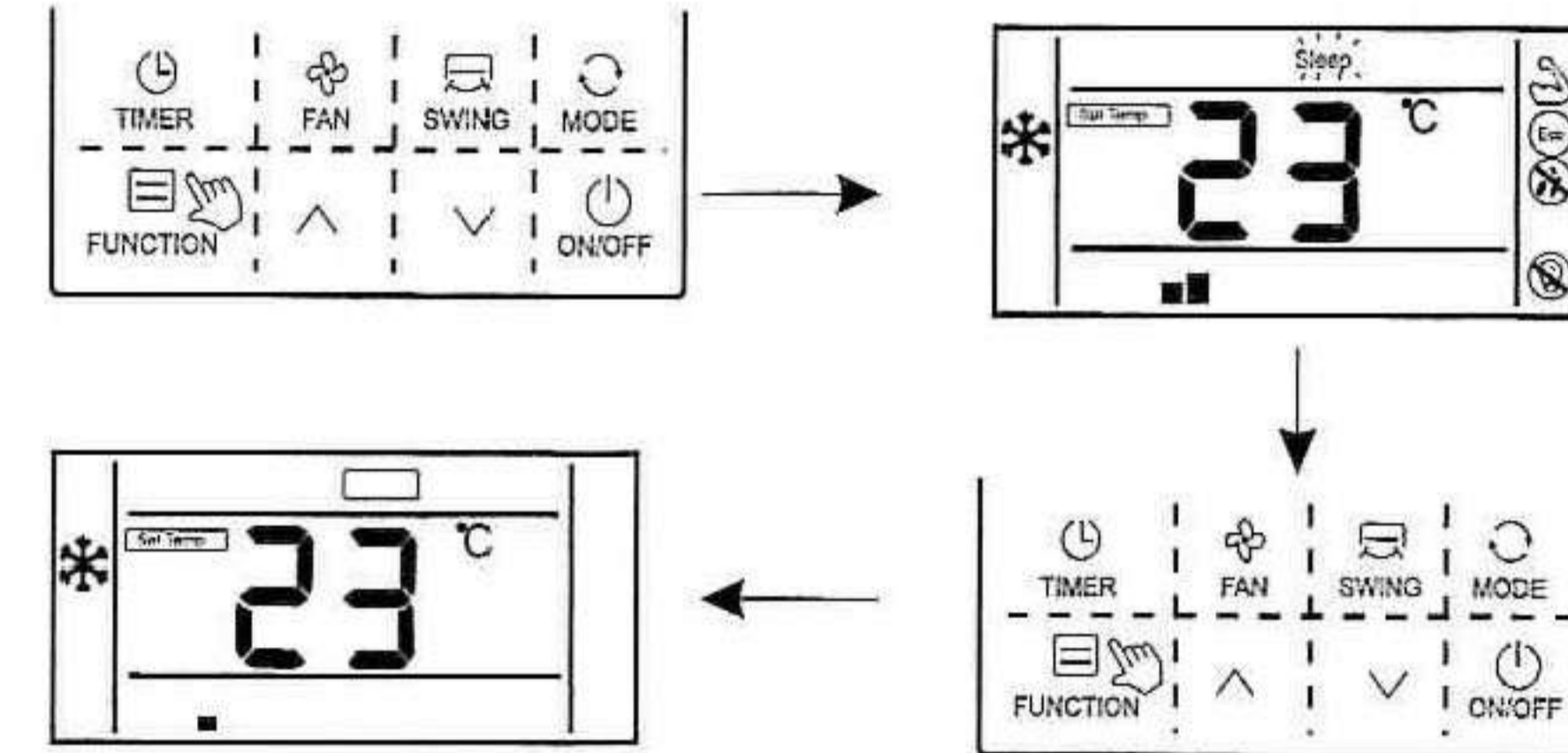

• The setting of "ECO" function

Enter ECO function:

1. Press "Function" button to enter the interface of function selection.
2. Press "▲" or "▼" button to switch to ECO function, at this moment,

- "Eco" icon is flashing;
 3. Press "Function" button again to confirm ECO function, at this moment, icon "Eco" is lighting.

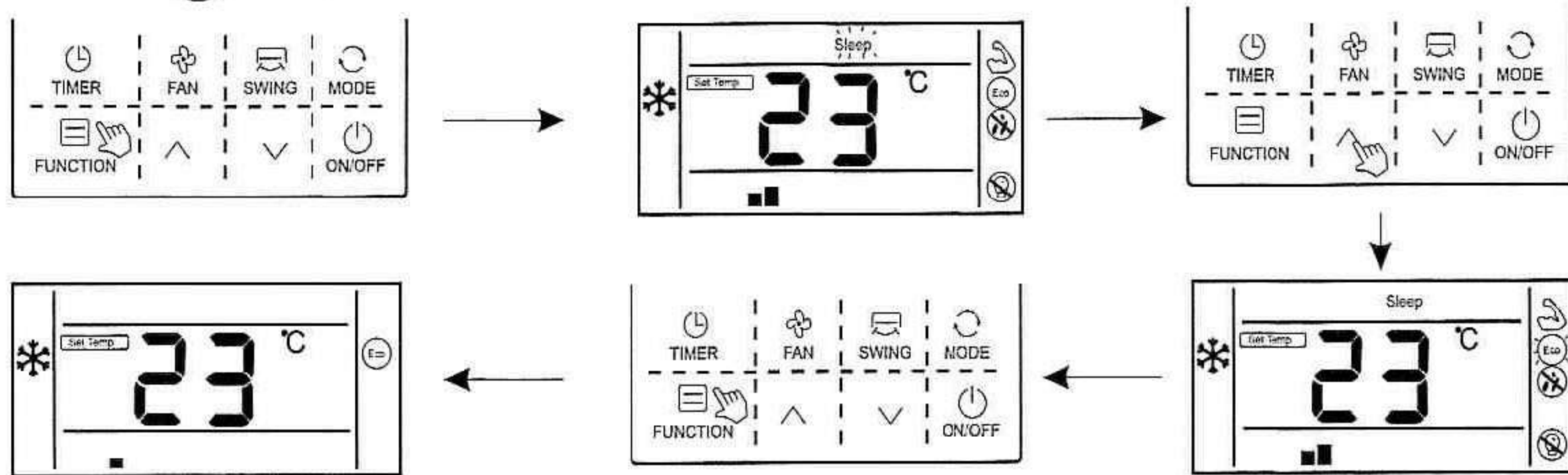

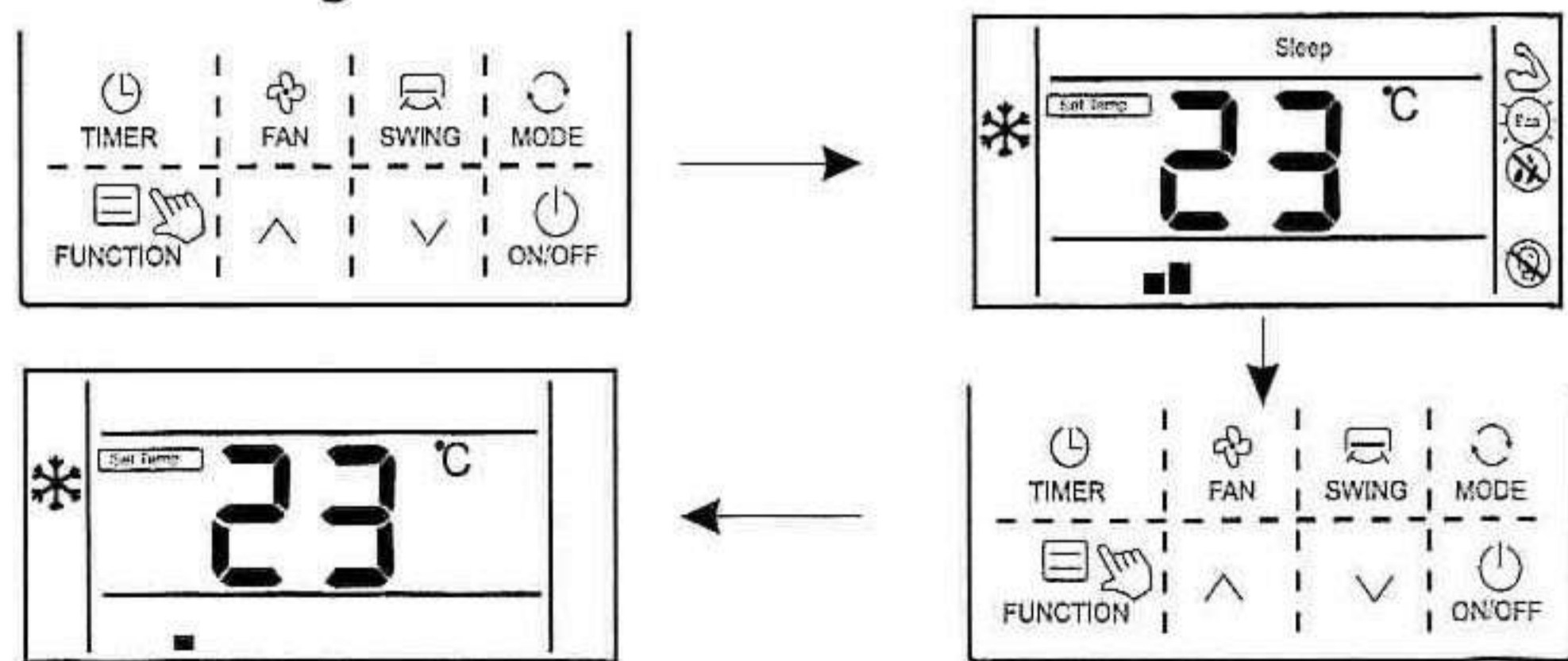

- Cancel ECO function:
 1. Press "Function" button to enter the interface of function selection.
 2. Press " ^ " or " v " button to switch to ECO function, at this moment, "Eco" icon is flashing;
 3. Press "Function" button again to cancel ECO function.



• The setting of "Mildew-proof" function



Mildew-proof function: After shutdown, the air conditioner would automatically dry the moisture in the evaporator of indoor unit, so as to avoid mildewing.

Enter mildew-proof function:

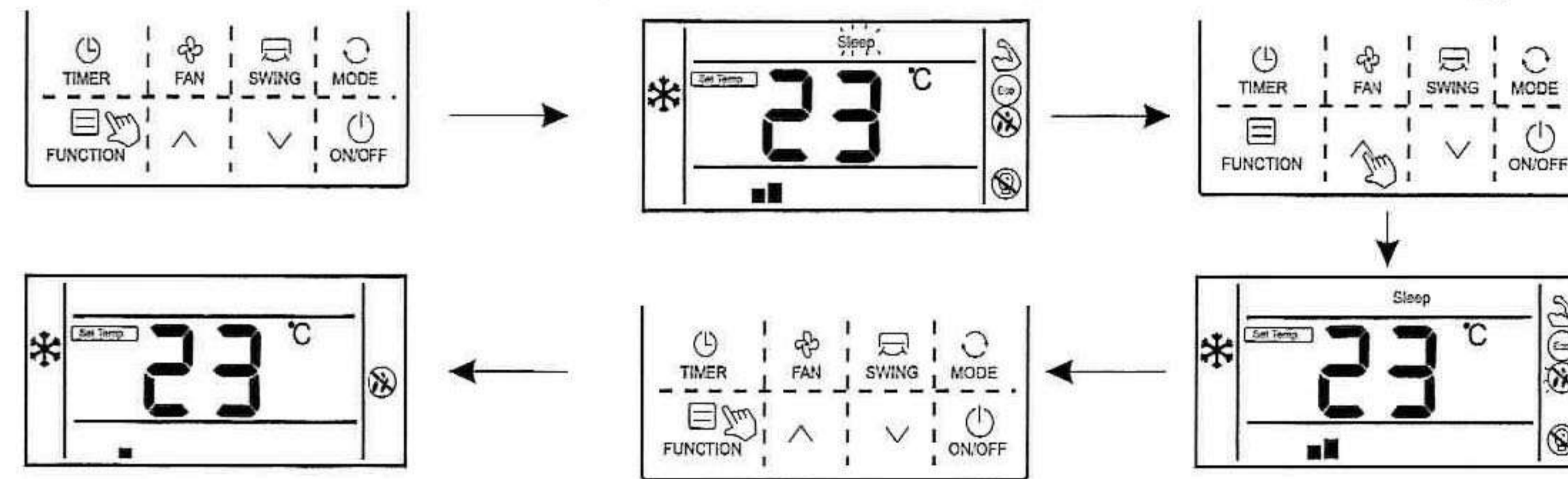
1. Under COOL and DRY mode, press "Function" button to enter the interface of function selection.
2. Press " ^ " or " v " button to switch to the mildew-proof function setting interface, at this moment, icon "  " is flashing;
3. Press "Function" button again to enter mildew-proof function, icon "  " is lighting.



Cancel fungus-proof function:

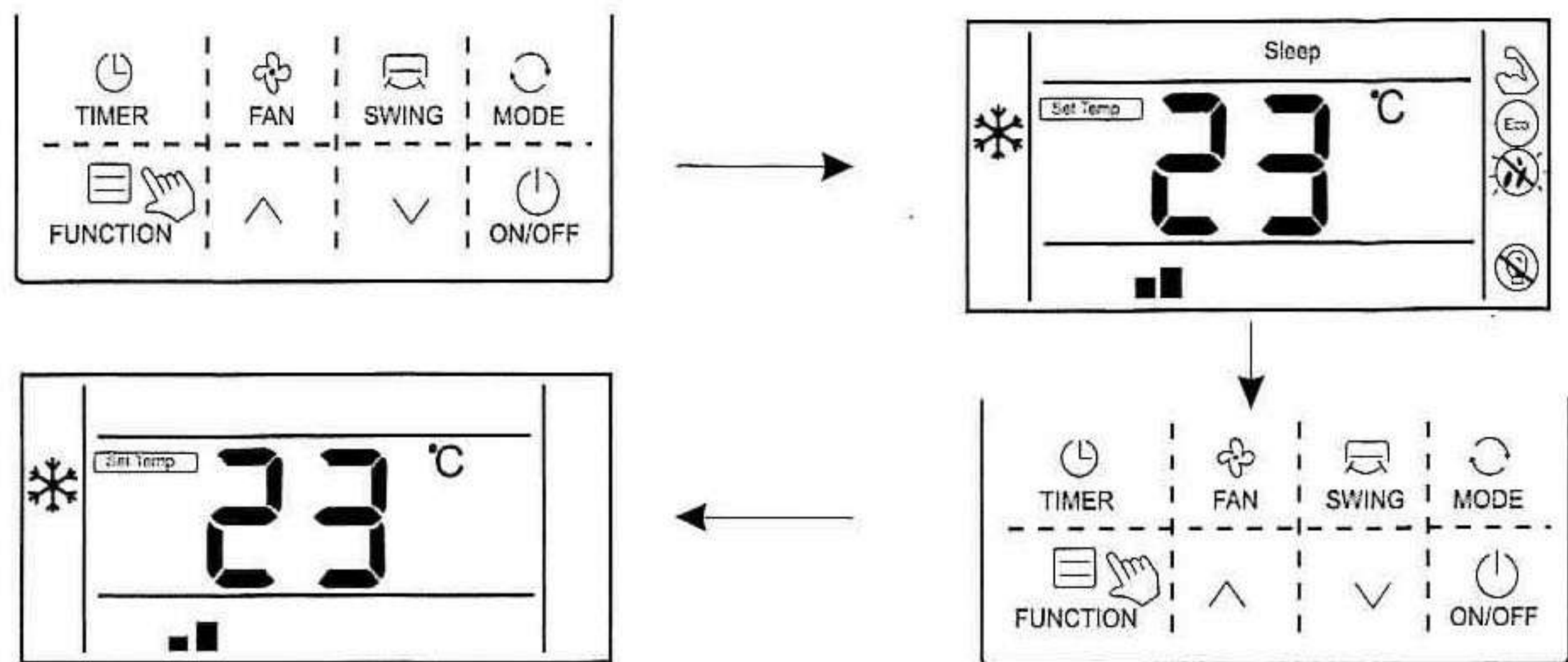

1. When mildew proof function is ON, press "Function" button to enter the interface of function selection.
2. Press " ^ " or " v " button to mildew proof function, icon "  " is flashing;
3. Press "Function" button again to cancel mildew proof function, icon will "  " disappear.



• The setting of "Light Sensation" function



Light sensation function: Detect the On and Off of indoor lamplight and switch to low fan speed when the lamplight is off, which can reduce the noise and create a comfortable sleep environment for users.

Enter light sensation function:

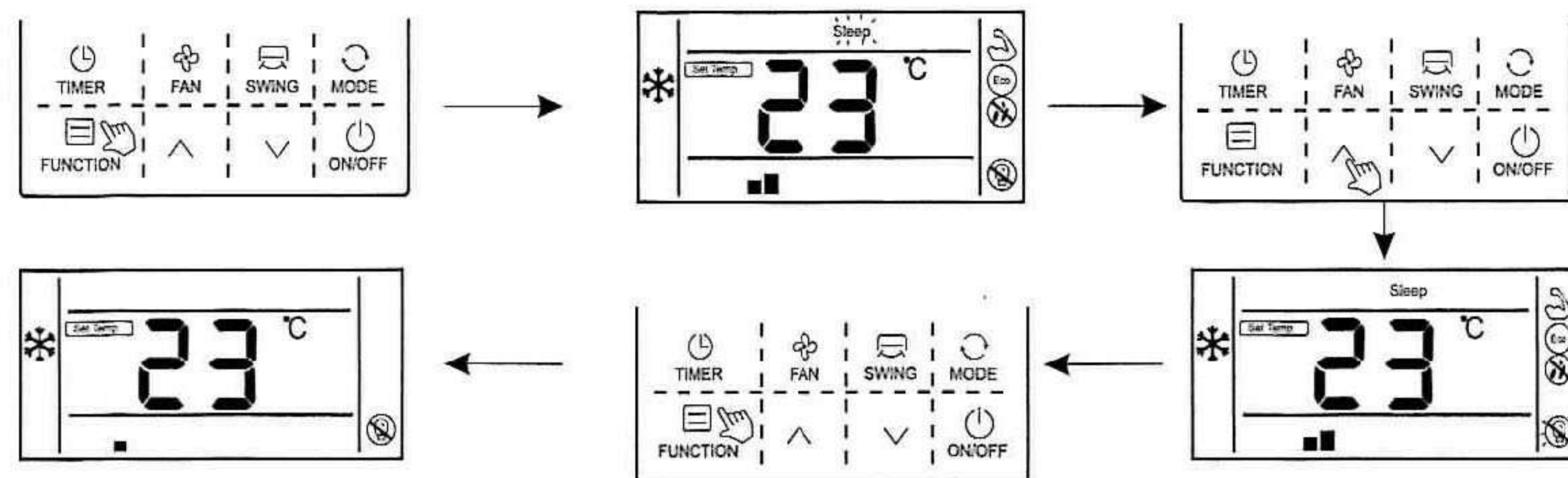
1. In the state of running, press "Function" button to enter the interface of function selection.
2. Press " ^ " or " v " to switch to light sensation function, icon "  " is flashing;
3. Press "Function" button again to enter light sensation function, at this moment, icon "  " is lighting.
4. When light sensation function is on, if the indoor lamplight is OFF and lasts for 20 minutes, the unit will automatically enter sleep mode. If the indoor lamplight is ON, and lasts for 20 minutes, the unit will cancel sleep mode and run according to the setting fan speed.



Cancel light sensation :

1. When light sensation function is on, press "Function" button to enter the interface of function selection.
2. Press " ^ " or " v " button to switch to light sensation function, icon "  " is flashing.
3. Press "Function" button again to cancel light sensation function, icon "  " will disappear.

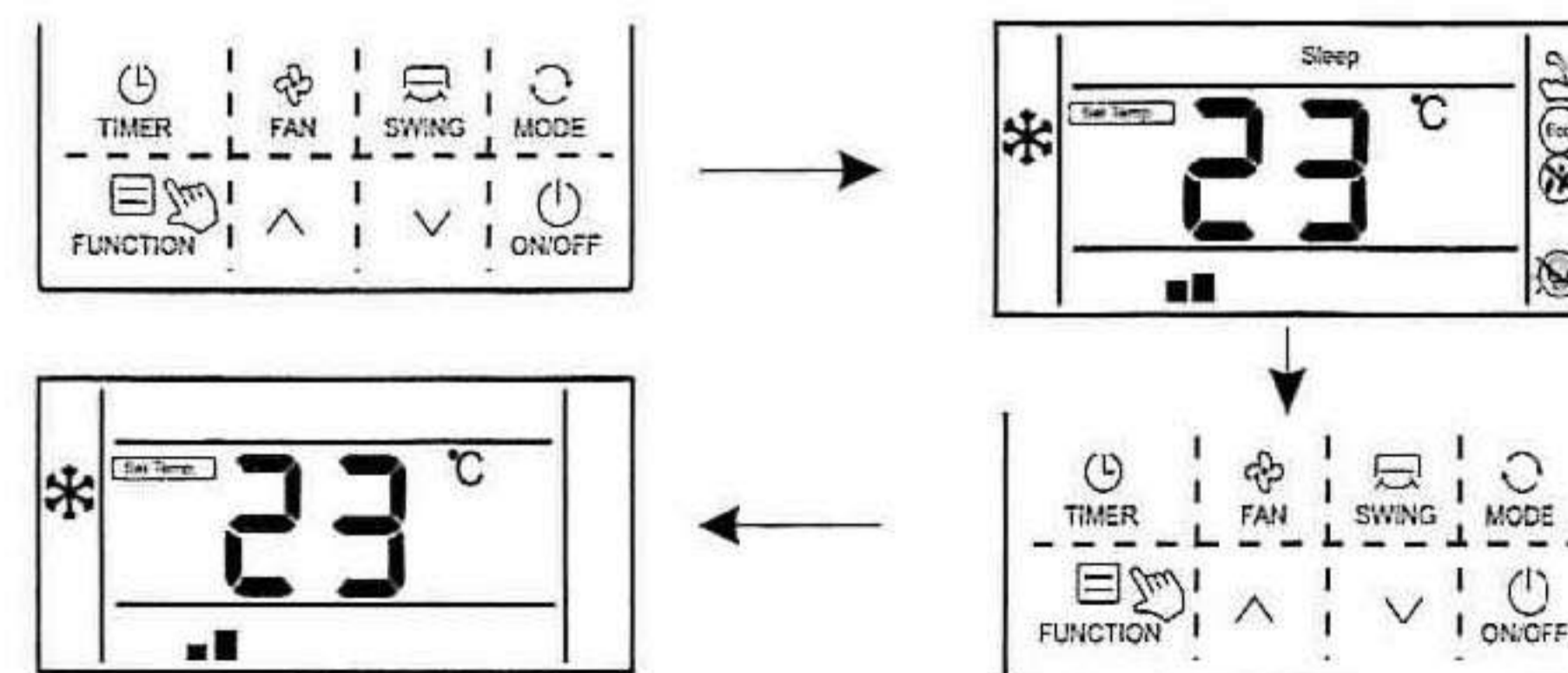

• The setting of "Clean" function

Clean function: The air conditioner can clean the evaporator automatically, which can not only keep air fresh, but also reduce the recession of cooling effect.

Enter clean function :

1. In the state of standby, press "Function" button to enter the interface of function selection, icon "Clean" is flashing.
2. Press "Function" button again to confirm clean function, at this moment, icon "Clean" is lighting.
3. When the unit is performing clean function, the wire controller will keep displaying icon "Clean", until it is finished.

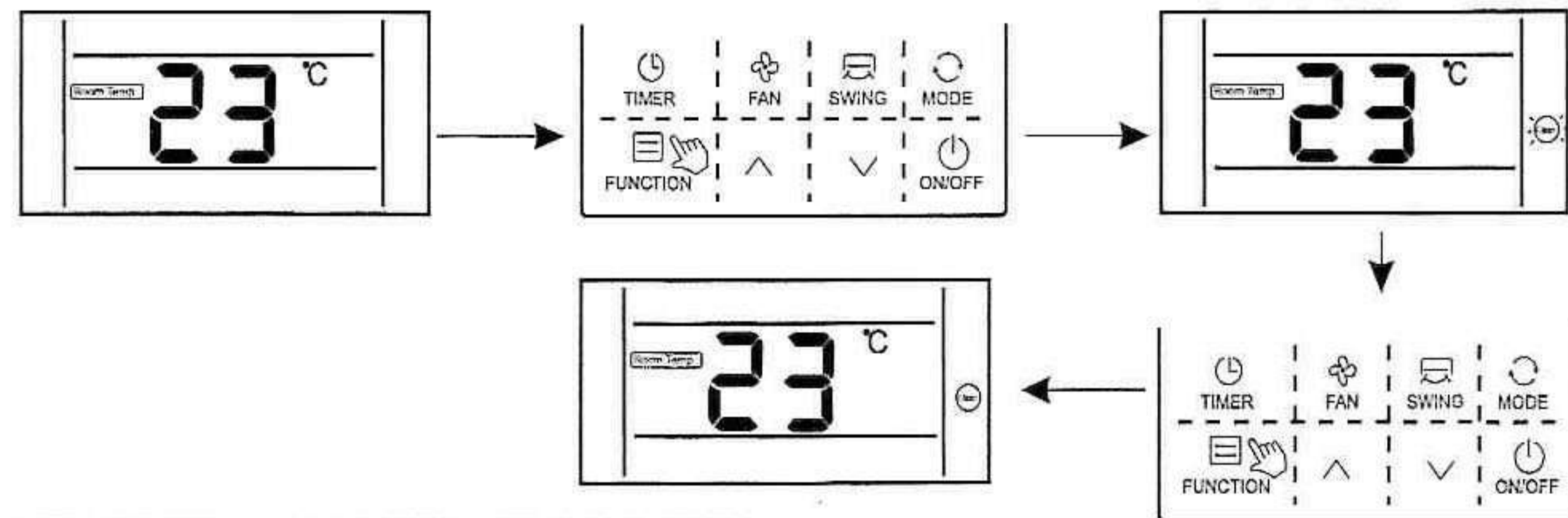

Display prompt function

• "WIFI" function display

If the unit is equipped with a WIFI function module, the icon "WiFi" is lighting on wire controller.

If the unit is not equipped with a WIFI function module, the icon "WiFi" does not display.

• "Shielding" function display

When unit is locked by centralized control, the wired controller will display "Shielding" icon.

• "Mute" function display

When the unit enter silent function, display "Mute" icon, when silent function is cancelled, the icon does not display.

Note: The unit without silent function can also set silent through wired controller, but it shows in the way of low wind grade, but "Mute" does not display.

• "Oil Return / Defrost" function display

When the unit is running in the state of Oil Return or Defrost, "Oil Return / Defrost" icon is lighting on wire controller.

When the unit has finished Oil Return or Defrost process, "Oil Return / Defrost" icon does not display.



• "Filter Screen Clean" function display

Filter screen cleaning reminder function: The unit can record its running time, When reaching the time set by the user, it will remind the user to clean the filter screen, so as to avoid prolonged cleaning and filter screen blockage, which can result in poor heating/cooling effect, abnormal protection, bacterial breeding, and other problems. When the running time reaches the filter screen cleaning reminder time set by a user, the unit will give out a reminder of filter screen cleaning, wired controller displays "Filter Screen Clean" icon, reminding the user to clean filter screen. At this moment long press "Timer" button for 5S to cancel the reminder, then the icon does not display. A filter screen cleaning reset signal is sent to the unit.

• Celsius and Fahrenheit switching display

When users set Celsius to be valid, the wired controller will display Celsius temperature. When users set Fahrenheit to be valid, the wired controller will display corresponding Fahrenheit temperature synchronously.

• **"Child Lock" function display**

Press both " ^ " and " v " buttons for more than 5S to enter locking, the controller will display "  ". In the state of locking, operations on the wired controller are disabled (but remote control receiving is valid). The method of unlocking: Press both " ^ " and " v " buttons for more than 5S or power off the unit to release the locking ("  " does not display).

• **Remote control function**

The wired controller can receive remote control commands and update the current status. Start-up the unit with remote controller, wired controller work in accordance with the state set on the remote controller and displays corresponding working mode.

• **Room temperature sensorequipped on the wired controller**

When the wire controller is equipped with a room temperature sensor and the sensor is not damaged, it is default that the ambient temperature detected by the sensor on the controller and the temperature value will be sent to the main PCB of the unit. If the wire controller is not equipped with a room sensor or the sensor is damaged, the room temperature will be detected by the temperature sensor of the unit itself.

• **Fault display**

When the unit has fault, the time bar will directly display the fault code and flash, the display mode is Er: MM (MM is the fault code, please read the corresponding product manual).

Installation of accessories

Please confirm whether the parts are complete.

No.	Name	Quantity	Remark
1	Wire controller	1	
2	Operation and installation instructions	1	

The following tools shall be prepared on site.

No.	Name	Quantity	Remark
1	Electrical box 86 *86	1	General electric box, embedded in wall.
2	Electrical tape	1	To be used at the time of wiring.
3	Big cross screwdriver	1	For the installation of electrical box.
4	Small flathead screwdriver	1	For dismantling the back cover of wire controller.
5	Shielded cable	1	The connection line embedded in wall (connect indoor unit to wired controller).

Installation location selection

(a) Flat surface

(b) The location of the room temperature can be accurately measured by the wire controller:

Sensors to monitor indoor temperature are located on indoor units and wire controllers. When the room temperature is monitored with the sensor on the wire controller, the built-in sensor of the wire controller monitors the room temperature. When using the sensor on the wire controller, follow the instructions below.

- To accurately monitor the indoor temperature, do not install the wire controller in direct sunlight, heat sources, and air supply outlets of the air conditioner.
- Install the wire controller in a position where the sensor can measure a representative room temperature.
- Install the wire controller on the ballad controller where no wires are laid around the temperature sensor. (If the wires are running, the sensors can't accurately measure the room temperature.)

Installation schematic—Magnet ring winding

If there is a magnetic ring in the inner attachment bag, be sure to wrap a magnetic ring around the shielded cable (near the wire controller end).

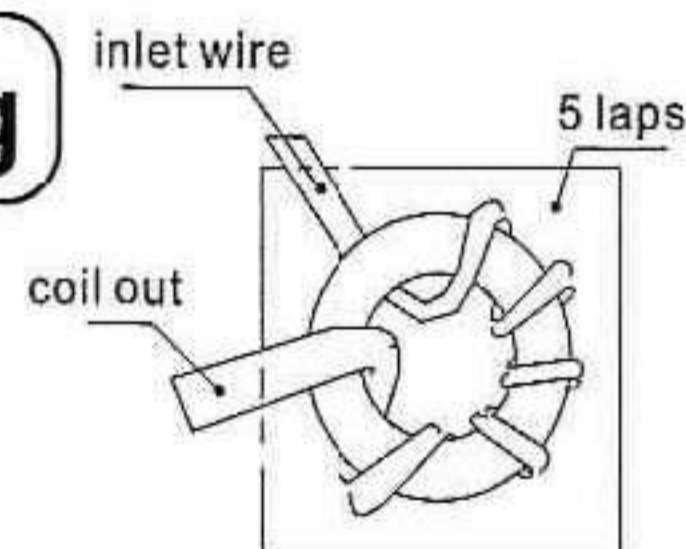

Installation schematic

1. Cut off the power of indoor unit.
2. As shown in Fig.1, use a flathead screw driver to pry the bottom groove of the wire controller lightly (too much force would damage circuit board), pry rotationally to open the back cover.

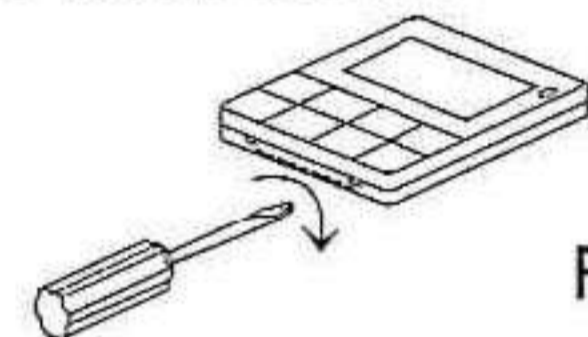

Fig.1

3. As shown in Fig.2, fix 4 * 20mm screws provided together with the back cover on 8 6 box, then pass lead wires through the back cover.

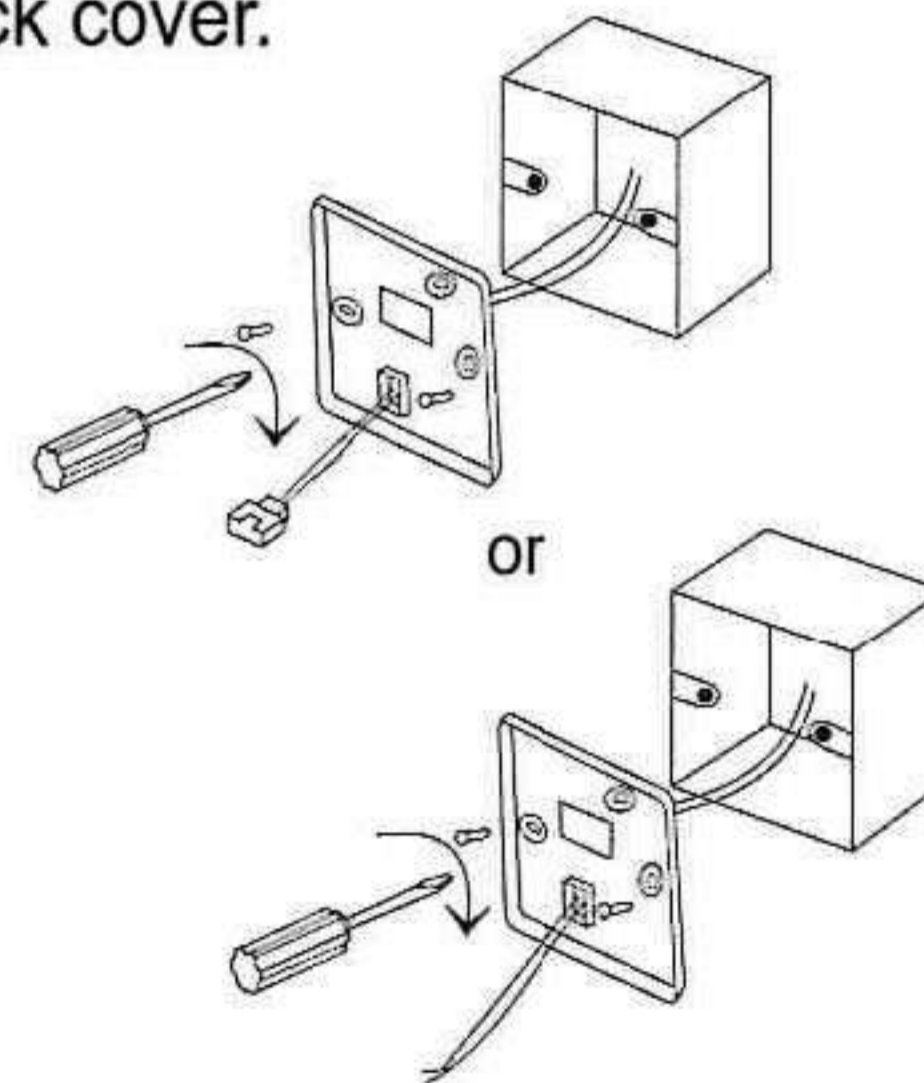

Fig.2

4. After connecting the connecting wire to the main body of the wire controller, as shown in Fig. 3, install main body part according to the following steps:

- 1). Push the upper part of main body into the clip.
- 2). Use the force of inclined top to install the lower part of main body (horizontal installation is prohibited, which is easy to damage the structural slot).

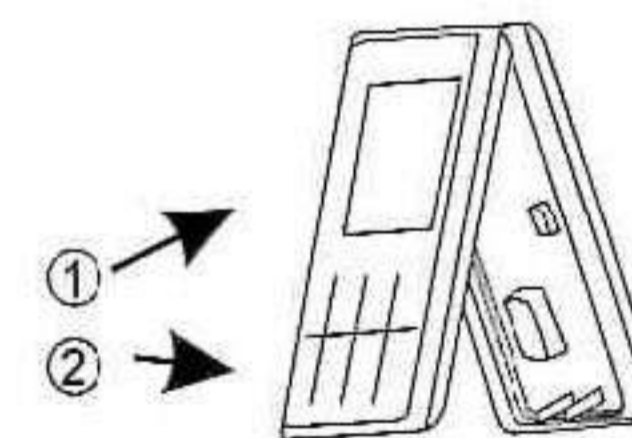

Fig.3