

MICROWAVE OVEN

USER MANUAL

EG9P032MX



Warning notices: Before using this product, please read this manual carefully and keep it for future reference. The design and specifications are subject to change without prior notice for product improvement. Consult with your dealer or manufacturer for details.

The diagram above is just for reference. Please take the appearance of the actual product as the standard.

THANK YOU LETTER

Thank you for choosing Midea! Before using your new Midea product, please read this manual thoroughly to ensure that you know how to operate the features and functions that your new appliance offers in a safe way.

CONTENTS

THANK YOU LETTER ----- 01

SAFETY INSTRUCTIONS ----- 02

SPECIFICATION ----- 12

PRODUCT OVERVIEW ----- 13

PRODUCT INSTALLATION ----- 16

OPERATION INSTRUCTIONS ----- 17

CLEANING AND MAINTENANCE ----- 23

TROUBLE SHOOTING ----- 24

TRADEMARKS, COPYRIGHTS AND LEGAL STATEMENT -- 25

SAFETY INSTRUCTIONS

Intended Use

The following safety guidelines are intended to prevent unforeseen risks or damage from unsafe or incorrect operation of the appliance. Please check the packaging and appliance on arrival to make sure everything is intact to ensure safe operation. If you find any damage, please contact the retailer or dealer. Please note modifications or alterations to the appliance are not allowed for your safety concern. Unintended use may cause hazards and loss of warranty claims.

Explanation of Symbols



Danger

This symbol indicates that there are dangers to the life and health of persons due to extremely flammable gas.



Warning of electrical voltage

This symbol indicates that there is a danger to life and health of persons due to voltage.



Warning

The signal word indicates a hazard with a medium level of risk which, if not avoided, may result in death or serious injury.



Caution

The signal word indicates a hazard with a low degree of risk which, if not avoided, may result in minor or moderate injury.



Attention

The signal word indicates important information (e.g. damage to property), but not danger.



Observe instructions

This symbol indicates that a service technician should only operate and maintain this appliance in accordance with the operating instructions.

Read these operating instructions carefully and attentively before using/commissioning the unit and keep them in the immediate vicinity of the installation site or unit for later use!

Precautions To Avoid Possible Exposure To Excessive Microwave Energy

- a. Do not attempt to operate this oven with the door open since this can result in harmful exposure to microwave energy. It is important not to break or tamper with the safety interlocks.
- b. Do not place any object between the oven front face and the door or allow soil or cleaner residue to accumulate on sealing surfaces.
- c. **WARNING:** If the door or door seals are damaged, the oven must not be operated until it has been repaired by a competent person.

Addendum

If the apparatus is not maintained in a good state of cleanliness, its surface could be degraded and affect the lifespan of the apparatus and lead to a dangerous situation.

Important Safety Instructions

⚠ WARNING

To reduce the risk of fire, electric shock, injury to persons or exposure to excessive microwave oven energy when using your appliance, follow basic precautions, including the following:

- Warning: Liquids and other foods must not be heated in sealed containers since they are liable to explode.
- Warning: It is hazardous for anyone other than a competent person to carry out any service or repair operation that involves the removal of a cover which gives protection against exposure to microwave energy.
- This appliance can be used by children aged from 8 years and above and persons with reduced physical, sensory or mental capabilities or lack of experience and knowledge if they have been given supervision or instruction concerning use of the appliance in a safe way and understand the hazards involved. Children shall not play with the appliance. Cleaning and user maintenance shall not be made by children unless they are older than 8 and supervised.
- Keep the appliance and its cord out of reach of children less than 8 years.
- Only use utensils that are suitable for use in microwave ovens.
- The oven should be cleaned regularly and any food deposits should be removed.
- Read and follow the specific: "PRECAUTIONS TO AVOID POSSIBLE EXPOSURE TO EXCESSIVE MICROWAVE ENERGY".

- When heating food in plastic or paper containers, keep an eye on the oven due to the possibility of ignition.
- If smoke is emitted, switch off or unplug the appliance and keep the door closed in order to stifle any flames.
- Do not overcook food.
- Do not use the oven cavity for storage purposes. Do not store items, such as bread, cookies, etc. inside the oven.
- Remove wire twist-ties and metal handles from paper or plastic containers/bags before placing them in the oven.
- Install or locate this oven only in accordance with the installation instructions provided.
- Eggs in their shell and whole hard-boiled eggs should not be heated in microwave ovens since they may explode, even after microwave heating has ended.
- This appliance is intended to be used in household and similar applications such as:
 - staff kitchen areas in shops, offices and other working environments;
 - by clients in hotels, motels and other residential type environments;
 - farm houses;
 - bed and breakfast type environments.
- If the supply cord is damaged, it must be replaced by the manufacturer, its service agent or similarly qualified persons in order to avoid a hazard.
- Do not store or use this appliance outdoors.
- Do not use this oven near water, in a wet basement or near a swimming pool.

- The temperature of accessible surfaces may be high when the appliance is operating. The surfaces are liable to get hot during use. Keep cord away from heated surface, and do not cover any vents on the oven.
- Do not let cord hang over edge of table or counter.
- Failure to maintain the oven in a clean condition could lead to deterioration of the surface that could adversely affect the life of the appliance and possibly result in a hazardous situation.
- The contents of feeding bottles and baby food jars shall be stirred or shaken and the temperature checked before consumption, in order to avoid burns.
- Microwave heating of beverages can result in delayed eruptive boiling, therefore care must be taken when handling the container.
- The appliance is not intended for use by persons (including children) with reduced physical, sensory or mental capabilities, or lack of experience and knowledge, unless they have been given supervision or instruction concerning use of the appliance by a person responsible for their safety.
- Children should be supervised to ensure that they do not play with the appliance.
- The appliances are not intended to be operated by means of an external timer or separate remote-control system.
- Accessible parts may become hot during use. Young children should be kept away.
- Steam cleaner is not to be used.
- During use the appliance becomes hot. Care should be taken to avoid touching heating elements inside the oven.

- Only use the temperature probe recommended for this oven. (for ovens provided with a facility to use a temperature-sensing probe.)
- **WARNING:** The appliance and its accessible parts become hot during use. Care should be taken to avoid touching heating elements. Children less than 8 years of age shall be kept away unless continuously supervised.
- The microwave oven must be operated with the decorative door open. (for ovens with a decorative door.)
- The rear surface of appliance shall be placed against a wall.
- The microwave oven must not be placed in a cabinet.
- The microwave oven is intended for heating food and beverages. Drying of food or clothing and heating of warming pads, slippers, sponges, damp cloth and similar may lead to risk of injury, ignition or fire.
- Metallic containers for food and beverages are not allowed during microwave cooking.
- The appliance must not be installed behind a decorative door in order to avoid overheating.

⚠ WARNING

When the appliance is operated in the combination mode, children should only use the oven under adult supervision due to the temperatures generated. The appliance must not be placed in a cabinet.

**READ CAREFULLY AND KEEP FOR FUTURE
REFERENCE**

To Reduce The Risk Of Injury To Persons Grounding Installation

⚠ DANGER

Electric Shock Hazard

Touching some of the internal components can cause serious personal injury or death. Do not disassemble this appliance.

⚠ WARNING

Electric Shock Hazard

Improper use of the grounding can result in electric shock. Do not plug into an outlet until appliance is properly installed and grounded.

This appliance must be grounded. In the event of an electrical short circuit, grounding reduces the risk of electric shock by providing an escape wire for the electric current.

This appliance is equipped with a cord having a grounding wire with a grounding plug. The plug must be plugged into an outlet that is properly installed and grounded.

Consult a qualified electrician or serviceman if the grounding instructions are not completely understood or if doubt exists as to whether the appliance is properly grounded.

If it is necessary to use an extension cord, use only a 3-wire extension cord.

- A short power-supply cord is provided to reduce the risks resulting from becoming entangled in or tripping over a longer cord.

- If a long cord set or extension cord is used:
 - The marked electrical rating of the cord set or extension cord should be at least as great as the electrical rating of the appliance.
 - The extension cord must be a grounding-type 3-wire cord.
 - The long cord should be arranged so that it will not drape over the counter top or tabletop where it can be pulled on by children or tripped over unintentionally.

Utensils

CAUTION

Personal Injury Hazard

It is hazardous for anyone other than a competent person to carry out any service or repair operation that involves the removal of a cover which gives protection against exposure to microwave energy.

See the instructions on "Materials you can use in microwave oven or to be avoided in microwave oven." There may be certain non-metallic utensils that are not safe to use for microwaving. If in doubt, you can test the utensil in question following the procedure below.

Utensil Test:

- Fill a microwave-safe container with 1 cup of cold water (250ml) along with the utensil in question.
- Cook on maximum power for 1 minute.
- Carefully feel the utensil. If the empty utensil is warm, do not use it for microwave cooking.
- Do not exceed 1 minute cooking time.

Materials you can use in microwave oven

Utensils	Remarks
Browning dish	Follow manufacturer's instructions. The bottom of browning dish must be at least 3/16 inch (5mm) above the turntable. Incorrect usage may cause the turntable to break.
Dinnerware	Microwave-safe only. Follow manufacturer's instructions. Do not use cracked or chipped dishes.
Glass jars	Always remove lid. Use only to heat food until just warm. Most glass jars are not heat resistant and may break.
Glassware	Heat-resistant oven glassware only. Make sure there is no metallic trim. Do not use cracked or chipped dishes.
Oven cooking bags	Follow manufacturer's instructions. Do not close with metal tie. Make slits to allow steam to escape.
Paper plates and cups	Use for short-term cooking/warming only. Do not leave oven unattended while cooking.
Paper towels	Use to cover food for reheating and absorbing fat. Use with supervision for a short-term cooking only.
Parchment paper	Use as a cover to prevent splattering or a wrap for steaming.
Plastic	Microwave-safe only. Follow the manufacturer's instructions. Should be labeled "Microwave Safe". Some plastic containers soften, as the food inside gets hot. "Boiling bags" and tightly closed plastic bags should be slit, pierced or vented as directed by package.
Plastic wrap	Microwave-safe only. Use to cover food during cooking to retain moisture. Do not allow plastic wrap to touch food.
Thermometers	Microwave-safe only (meat and candy thermometers).
Wax paper	Use as a cover to prevent splattering and retain moisture.

Materials to be avoided in microwave oven

Utensils	Remarks
Aluminum tray	May cause arcing. Transfer food into microwave-safe dish.
Food carton with metal handle	May cause arcing. Transfer food into microwave-safe dish.
Metal or metal-trimmed utensils	Metal shields the food from microwave energy. Metal trim may cause arcing.
Metal twist ties	May cause arcing and could cause a fire in the oven.
Paper bags	May cause a fire in the oven.
Plastic foam	Plastic foam may melt or contaminate the liquid inside when exposed to high temperature.
Wood	Wood will dry out when used in the microwave oven and may split or crack.

SPECIFICATION

Product Model	EG9P032MX
Rated Voltage	230V~ 50Hz
Rated Input Power(microwave):	1450W
Rated Output Power(microwave):	900W
Rated Input Power (Grill):	1000W

PRODUCT OVERVIEW

Names Of Oven Parts And Accessories

Remove the oven and all materials from the carton and oven cavity. Your oven comes with the following accessories:

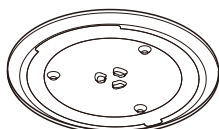

Glass Tray

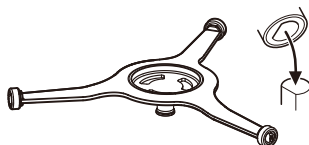

Turntable Ring Assembly

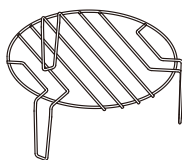

Grill Rack(Can not be used in microwave function and must be placed on the glass tray)



Instruction Manual

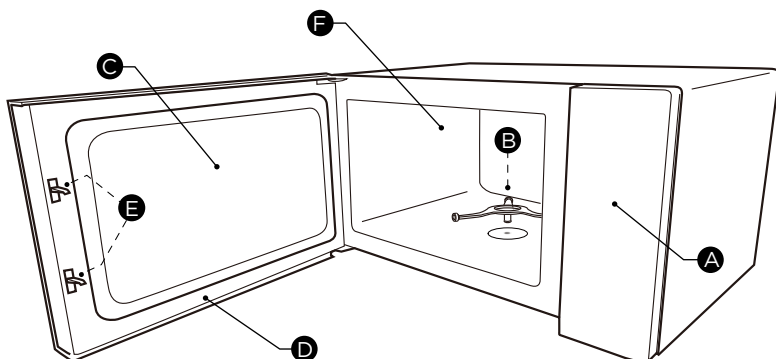

A) Control panel

B) Turntable Ring Assembly

C) Observation window

D) Door assembly

E) Safety interlock system

F) Oven cavity

Names Of Oven Parts And Accessories

Cleaning the cooking compartment and putting the turntable in place. For new installations, make sure all packaging and shipping tape has been removed. Before using the appliance to prepare food for the first time, you will need to put the turntable in place correctly. You must clean the cooking compartment and accessories.

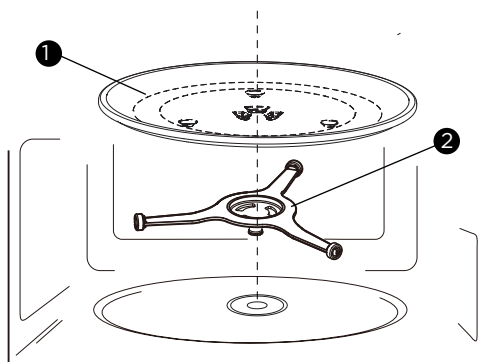

1) Glass Tray

2) Turntable Ring Assembly

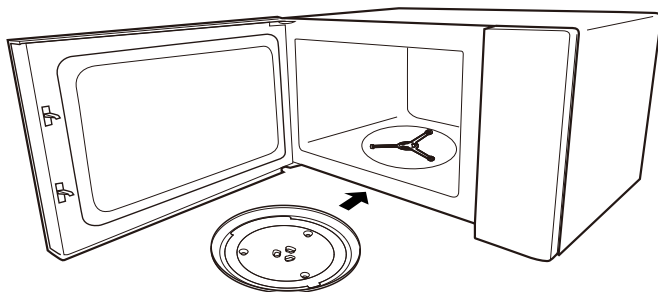

NOTE

- Never use the appliance without the turntable. Make sure that it is properly engaged. The turntable can turn clockwise or anti-clockwise.
- Never place the glass tray upside down. The glass tray should never be restricted.
- Both glass tray and turntable ring assembly must always be used during cooking.
- All food and containers of food are always placed on the glass tray for cooking.
- Never restrict the movement of the turntable.
- If glass tray or turntable ring assembly cracks or breaks, contact your nearest authorized service center.

PRODUCT INSTALLATION

Countertop Installation

Remove all packing material and accessories. Examine the oven for any damage such as dents or broken door. Do not install if oven is damaged.

Cabinet: Remove any protective film found on the microwave oven cabinet surface. Do not remove the light brown Mica cover that is attached to the oven cavity to protect the magnetron.

Installation

1. Select a level surface that provide enough open space for the intake and/or outlet vents.

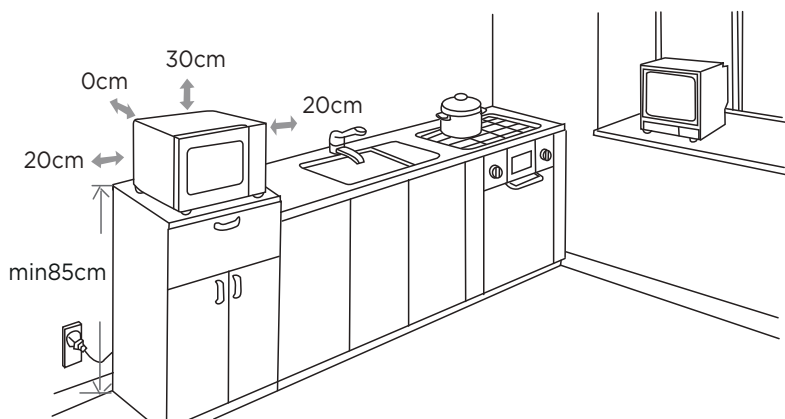

- The minimum installation height is 85cm.
 - The rear surface of appliance shall be placed against a wall. Leave a minimum clearance of 30cm above the oven, a minimum clearance of 20cm is required between the oven and any adjacent walls.
 - Do not remove the legs from the bottom of the oven.
 - Blocking the intake and/ or outlet openings can damage the oven.
 - Place the oven as far away from radios and TV as possible. Operation of microwave oven may cause interference to your radio or TV reception.
2. Plug your oven into a standard household outlet. Be sure the voltage and the frequency is the same as the voltage and the frequency on the rating label.

WARNING

Do not install oven over a range cooktop or other heat-producing appliance. If installed near or over a heat source, the oven could be damaged and the warranty would be void.

The accessible surface may be hot during operation.



OPERATION INSTRUCTIONS



Setting the Clock

1. Press “^{TIMER}
CLOCK
ساعة التوقيت” twice and then “00:00” will display.
2. Press number keys to enter the time.
Example: To set the clock to 12:10, please press “1,2,1,0” in turn.
3. Press “^{TIMER}
CLOCK
ساعة التوقيت” to confirm. The clock is set.
4. If the entered number is not within the range of 1:00-12:59, the setting is invalid.

NOTE

- In the process of clock setting, if the “^{STOP}
Cancel / LOCK +3S
إيقاف/إلغاء قفل + 3 دقيقة” button is pressed or if there is no operation within 1 minute, the oven will return to the former setting.
- To reset the clock, please repeat step 1 to step 3.

Microwave Cooking

Power levels chart

Level	Power	Display
10	100%	PL10
9	90%	PL9
8	80%	PL8
7	70%	PL7
6	60%	PL6
5	50%	PL5
4	40%	PL4
3	30%	PL3
2	20%	PL2
1	10%	PL1
0	0%	PL0

1. Press “^{MICRO.}
ميكروويف”, “PL10” and then press number keys to adjust the power level.
The 11 power levels are available.
2. Press “^{COOK}
TIME
وقت الطبخ” and then “00:00” will display.
3. Press number keys to enter cooking time. The maximum time value is “99:99”.
4. Press “^{START}
+30sec.
بدء/30 ثانية” to start cooking.

NOTE

- In the process of setting, if the “^{STOP}
Cancel / LOCK +3S
إيقاف/القفل + 3 دقيقة” button is pressed or if there is no operation within 1 minute, the setting is invalid.
- In the process of cooking, you can press “^{START}
+30sec.
بدء + 30 ثانية” to increase cooking time.
- The power level can be changed during operation. Press “^{MICRO.}
ميكرويف” and then the current power will flash for 3 seconds. Press number keys to change the power. The oven will work with the selected power.

Setting the Kitchen Timer

1. Press “^{TIMER}
CLOCK
ساعة التوقيت” once and then “00:00” will display.
2. Press number keys to enter the desired time. The maximum time value is “99:99”.
3. Press “^{START}
+30sec.
بدء + 30 ثانية” to confirm. The timer starts counting down.

NOTE

The kitchen timer is a timer. In the process of setting, if the “^{STOP}
Cancel / LOCK +3S
إيقاف/القفل + 3 دقيقة” button is pressed, the oven will enter waiting state.

Grill Cooking

1. Press “^{COMBI.}
الكمبي” once and then “G-1” will display.
2. Press “^{COOK}
TIME
وقت الطبخ” once and then “00:00” will display.
3. Press number keys to enter the desired time. The maximum time value is “99:99”.
4. Press “^{START}
+30sec.
بدء + 30 ثانية” to start cooking.

NOTE

In the process of cooking, you can press “^{START}
+30sec.
بدء + 30 ثانية” to increase cooking time.

Combination Cooking

1. Press “^{COMBI.}
الكمبي” once and then “G-1” will display. Press it repeatedly to select “C-1” or “C-2”.
2. Press “^{COOK}
TIME
وقت الطبخ” once and then “00:00” will display.
3. Press number keys to enter the desired time. The maximum time value is “99:99”.
4. Press “^{START}
+30sec.
بدء + 30 ثانية” to start cooking.

NOTE

In the process of cooking, you can press “^{START}
+30sec.
بدء + 30 ثانية” to increase cooking time.

Speedy Cooking

1. In waiting state, pressing number keys 1 to 6 let you quickly select a cooking time from 1 to 6 minutes with PL10.
2. In waiting state, press “^{START}_{+30sec.}” to cook food with 100% power level for 30 seconds.
بدء/30+ ثانية



NOTE

You can press “^{START}_{+30sec.}” to increase the cooking time during cooking.
بدء/30+ ثانية

Defrost by Weight

1. Press “^{WGT.}_{إذابة التجميد (وزن)} DEFROST ” and then the screen will display “dEF1”.
2. Press number keys to enter the weight of food. The range of weight is 100-2000g.
3. Press “^{START}_{+30sec.}” to start defrosting.
بدء/30+ ثانية
4. Once defrosting has finished, the buzzer will sound five times.

Silent Mode

1. To activate the silent mode:
In waiting state, press and hold “8” for 3 seconds. A long beep will sound. When you press the keys, it does not make a sound.
2. To deactivate the silent mode:
In silent mode, press and hold “8” for 3 seconds. A long beep will sound.

ECO Function

1. To enter ECO mode:
In waiting state, press “^{ECO}_{الاقتصادي}”. The screen will turn off.
2. To cancel ECO mode:
In ECO mode, press any key, close or open the door to wake up the screen.

Deodorizer Function

1. In waiting state, press “**DEODORIZER**” مزيل الروائح and then “10:00” will display.
2. Press “**START**” +30sec. بدء 30+ ثانية to start working for 10 minutes.

Memory Function

You can save the settings for a dish in the memory and call it up again.

1. Press “**MEMORY**” الذاكرة to select memory 1-3 procedure. “1”, “2” and “3” will display in order.
2. If the procedure has been set, press “**MEMORY**” الذاكرة to start working. Otherwise, continue to set.
3. After finishing the setting, press “**START**” +30sec. بدء 30+ ثانية once to save the procedure.

Example: Set memory 2 (cook food with 80% microwave power for 3 minutes)

1. In waiting state, press “**MEMORY**” الذاكرة twice.
2. Press “**MICRO.**” ميكروويف and then press number key “8”.
3. Press “**COOK TIME**” وقت الطبخ and then press number keys “3”, “0”, “0” in order.
4. Press “**START**” +30sec. بدء 30+ ثانية to save the setting and “2” will display.



NOTE

- If the power is not cut off, the procedure will be saved all the time.
- Auto menu can not be set in memory function.

Multi-Stage Cooking



NOTE

- Up to two cooking stages can be set in multi-stage cooking.
- If you set defrost function, it will work automatically in the first stage.
- Auto menu, speed cooking, deodorization and kitchen timer cannot be set as one of the multi-stage.

Example: Defrost 100g food and then cook with 80% microwave power for 7 minutes.

1. Press “**WGT. DEFROST**” إذابة التجميد (وزن) and then the screen will display “dEF1”.
2. Press “1”, “0”, “0” to set the desired defrost weight.
3. Press “**MICRO.**” ميكروويف.
4. Press “8” to set the power level of PL8.
5. Press “**COOK TIME**” وقت الطبخ and then press “7”, “0”, “0” to set the cooking time.

6. Press “ ^{+30sec.}START ” to start cooking.
بدء 30+ ثانية

NOTE

In the process of cooking, you can press “ ^{+30sec.}START ” to increase cooking time. (except Defrost by Weight)
بدء 30+ ثانية

Inquiring Function

If the clock has been set, the current time will display for three seconds by pressing

“ ^{TIMER}CLOCK ” in the cooking state.
ساعة التوقيت

Lock Function for Children

1. You can use this function to prevent children from accidentally turning the oven on.

To activate the lock:

2. In waiting state, press and hold “ ^{STOP}Cancel / ^{LOCK +3S}قفّل + 3 دقيقة ” for three seconds. A long beep sounds and the locked icon will display.
إيقاف/إلغاء

3. To deactivate the lock:

In locked state, press and hold “ ^{STOP}Cancel / ^{LOCK +3S}قفّل + 3 دقيقة ” for three seconds. A long beep sounds.
إيقاف/إلغاء

Auto Menu

1. Press a menu key repeatedly to choose the weight you want to cook. For example, press “ ^{PARATHA}براثا ” once and “250” will display.

2. Press “ ^{+30sec.}START ” to start cooking.
بدء 30+ ثانية

Auto Menu Chart

Menu	Weight	Display
A-1 PARATHA	250g (about 6)	250
	500g (about 12)	500
	750g (about 18)	750
A-2 SOUP	1 bowl (about 200ml)	1
	2 bowls	2
	3 bowls	3
A-3 REHEAT	150g	150
	250g	250
	350g	350
	650g	650
A-4 BEVERAGE	1 cup (120ml)	1
	2cups	2
	3cups	3
A-5 POTATO	1 (230g)	1
	2	2
	3	3
A-6 POPCORN	100g	100
A-7 MEAT	250g	250
	350g	350
	450g	450
A-8 CHICKEN	250g	250
	450g	450
	650g	650
A-9 FISH	250g	250
	450g	450
	650g	650
A-10 PIZZA	1 (about 255g)	1
A-11 LASANHA	350g	350
	650g	650

CLEANING AND MAINTENANCE

Be sure to unplug the appliance from the power supply.

- Clean the cavity of the oven after using with a slightly damp cloth.
- Clean the accessories in the usual way in soapy water.
- The door frame and seal and neighbouring parts must be cleaned carefully with a damp cloth when they are dirty.
- Do not use harsh abrasive cleaners or sharp metal scrapers to clean the oven door glass since they can scratch the surface, which may result in shattering of the glass.
- Cleaning Tip---For easier cleaning of the cavity walls that the food cooked can touch: Place half a lemon in a bowl, add 300ml (1/2 pint) water and heat on 100% microwave power for 10 minutes. Wipe the oven clean using a soft, dry cloth.

TROUBLE SHOOTING

Normal	
Microwave oven interfering TV reception	Radio and TV reception may be interfered when microwave oven operating. It is similar to the interference of small electrical appliances, like mixer, vacuum cleaner, and electric fan. It is normal.
Dim oven light	In low power microwave cooking, oven light may become dim. It is normal.
Steam accumulating on door, hot air out of vents	In cooking, steam may come out of food. Most will get out from vents. But some may accumulate on cool place like oven door. It is normal.
Oven started accidentally with no food in.	It is forbidden to run the unit without any food inside. It is very dangerous.

Trouble	Possible Cause	Remedy
Oven can not be started.	• Power cord is not plugged in tightly.	• Unplug. Then plug again after 10 seconds.
	• Fuse blowing or circuit breaker works.	• Replace fuse or reset circuit breaker (repaired by professional personnel of our company)
	• Trouble with outlet.	• Test outlet with other electrical appliances.
Oven does not heat.	• Door is not closed well.	• Close door well.



According to Waste of Electrical and Electronic Equipment (WEEE) directive, WEEE should be separately collected and treated. If at any time in future you need to dispose of this product please do NOT dispose of this product with household waste. Please send this product to WEEE collecting points where available.

TRADEMARKS, COPYRIGHTS AND LEGAL STATEMENT

 Midea logo, word marks, trade name, trade dress and all versions thereof are valuable assets of Midea Group and/or its affiliates ("Midea"), to which Midea owns trademarks, copyrights and other intellectual property rights, and all goodwill derived from using any part of an Midea trademark. Use of Midea trademark for commercial purposes without the prior written consent of Midea may constitute trademark infringement or unfair competition in violation of relevant laws.

This manual is created by Midea and Midea reserves all copyrights thereof. No entity or individual may use, duplicate, modify, distribute in whole or in part this manual, or bundle or sell with other products without the prior written consent of Midea.

All the described functions and instructions were up to date at the time of printing this manual. However, the actual product may vary due to improved functions and designs.



make yourself at home



www.midea.com

© Midea 2022 all rights reserved