

INTELLIGENT ELECTRONIC SAFE

! Please do not keep emergency keys in your safe!

Dear valued customer:

Thank you for choosing our products! You've taken an important step in organizing and protecting your most valued possessions. Every series of our safes is professionally made and designed to provide safety. Please take time to read and familiarize yourself with the proper operating procedures of your new safe presented on the following pages.

Again, thank you for choosing our products!

Schematic drawing of case

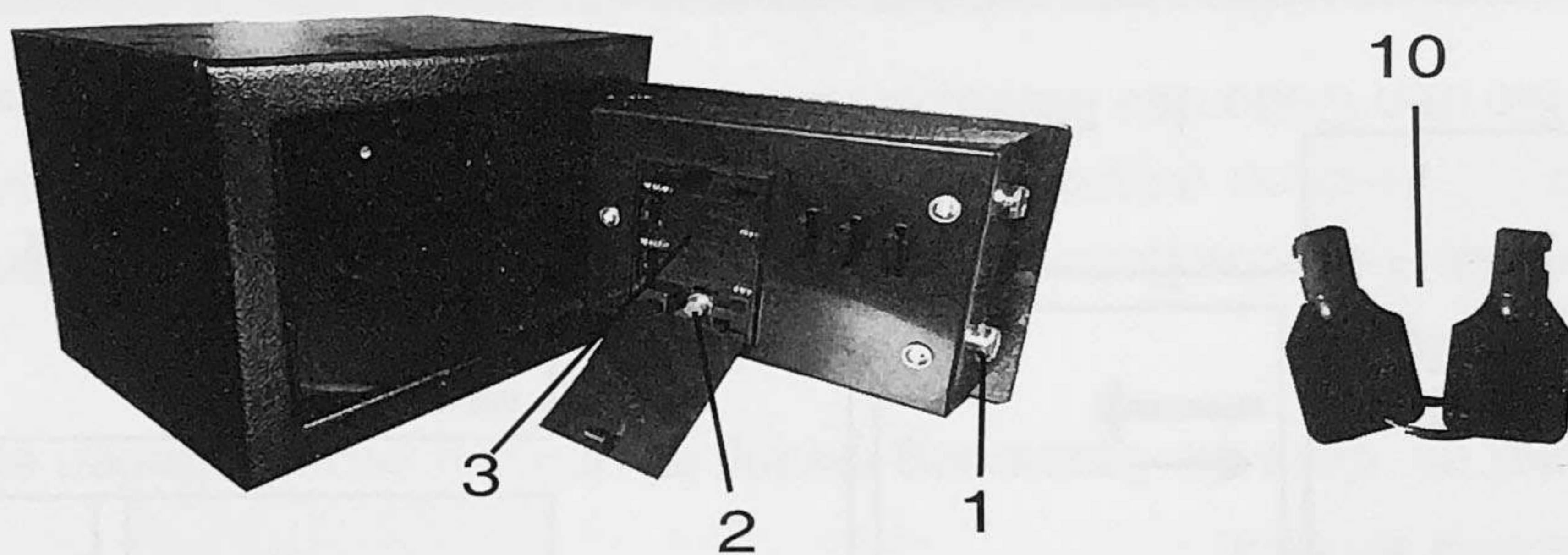

Schematic drawing of control panel

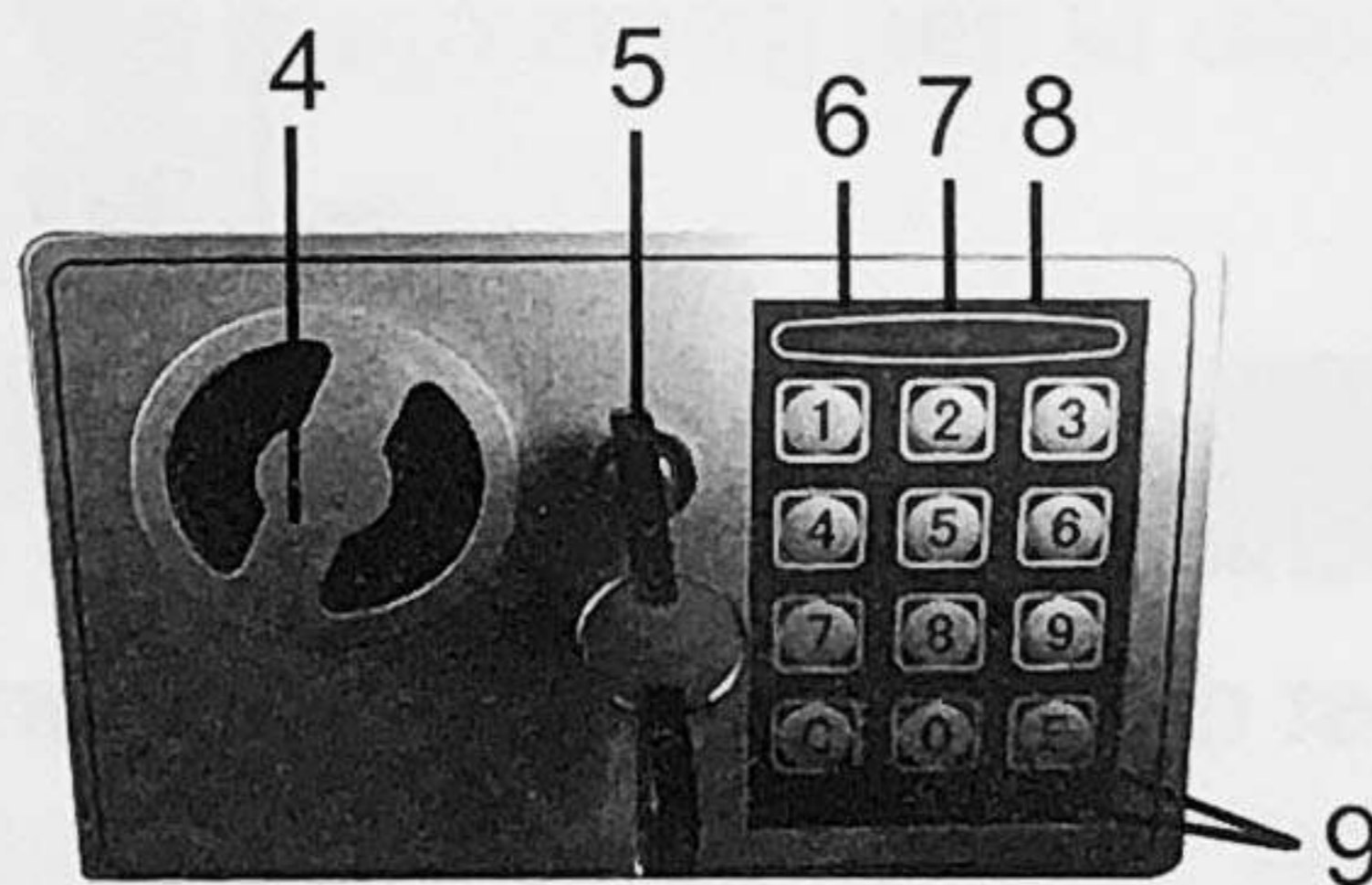

- | | | |
|------------------------|-------------------------|----------------------|
| 1. Bolts | 5. Emergency Lock Cover | 9. Confirming button |
| 2. Reset Button | 6. Green Light | 10. Emergency Key |
| 3. Battery Compartment | 7. Red Light | |
| 4. Knob (Master Key) | 8. Yellow Light | |

! CAUTION: All drawings in this manual have been prepared based on the EA. The exterior design or component positions of other models may be different from what is indicated in the drawings, while the operation is the same.

SMS-00-EA01
MADE IN CHINA

OPENING YOUR SAFE FOR THE FIRST TIME

Upon first opening, users should open the safe with the emergency key. The operation in details refers to "opening the safe with the emergency key".

- Remove emergency lock cover, then insert the emergency key, press it and turn it count clockwise at the same time.
- Turn the knob (master key) clockwise to open the door.

⚠ CAUTION: Finish operation, pull out the emergency key clockwise and keep it in a safe place (don't keep emergency keys in your safe)

INSERTING THE BATTERIES

- Open the door.
- Insert 4 X AA batteries into the battery compartment.
- Under normal condition, if both of the red and the green lights are on at the same time, it means the voltage is low and you should insert new batteries.

⚠ CAUTION: Buy 4 Carbon batteries and line them up in a manner as indicated by the "+" and "-" signs. then reset the user's code.

Note: you should reset your code after replace the old batteries.

RESETTING THE USER CODE

- Firstly open the door, and you'll see the reset button after opening the battery cover.
- Once you press the reset button, you should start to setting the new code (3 to 8 digits) in 30 seconds when the yellow lights all go on.
- Press "C" or "E" button to confirm with 2 buzzer beeps, which indicates the acceptance and storage of the new code.
- If the yellow light flashes with 3 buzzer beeps, which means the code changing is not effective, and you need to try again.
- CAUTION: The user preset code is '159'.

CLOSING DOOR

- If the emergency key is used to open the safe, close the safe door, turn the emergency key clockwise and pull it out, and turn the handle counterclockwise;
- If you use the password to open the safe, close the door of the safe and turn the handle counterclockwise;

OPENING DOOR

- Input your user's new code (3 to 8 digits, refer to pic 1), each pressing results one buzzer beep and yellow light flashes.
- Press "C" or "E" button, the green light will be on.
- Rotate the knob (master key) clockwise and pull outwards within 5 seconds, the door is opened. (refer to pic 2)

❗ **CAUTION:** Please input the user code again if the yellow light flashes with three buzzer beeps.



pic 1



pic 2

KEYBOARD LOCKOUT

- 3 continuously wrong entries will activate the warning beep for 20 seconds.

❗ **CAUTION:** The key pad would be disabled during the beeping. You can only stop the beeps by opening the safe with emergency key and power-cut by removing the battery.

OPENING THE SAFE WITH THE EMERGENCY KEY

Upon first receipt of the safe, or either the electronic circuit malfunction or codes unknown. You could also use the emergency key to open the safe.

- Remove the cover of the emergency lock. (pic 3)
- Insert the emergency key (pic 4), press it and turn it count clockwise at the same time, then turn the knob (master key) clockwise (pic 5) to open the door.



pic 3



pic 4



pic 5

MOUNTING METHOD

Fix the safe in the place which is not easy to move.

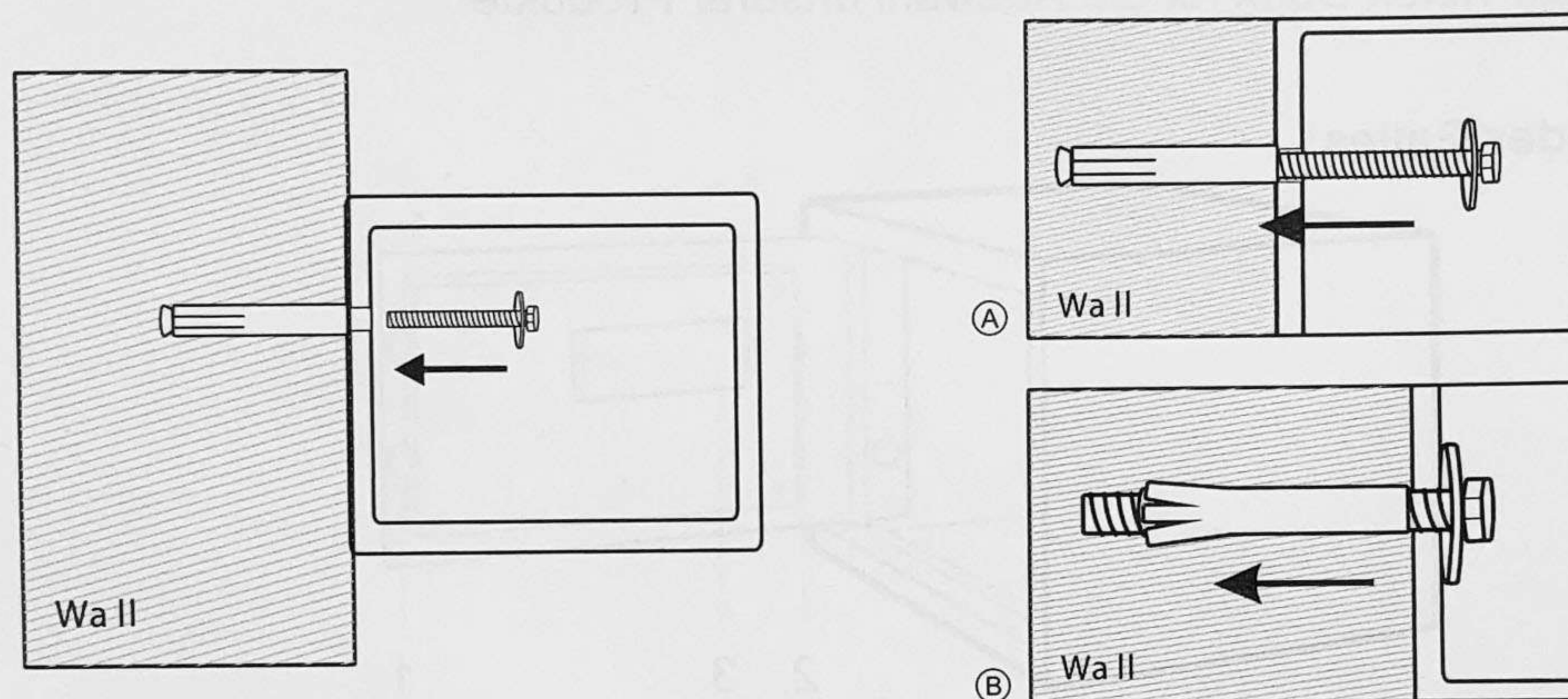

- Drill holes for expansion bolts (or clamping screws) in the right place.
- Turn the expansion bolts counter clockwise to separate.
- Use the expansion bolts (or clamping screws) to secure the case to the wall.
- Make sure the case is mounted in place as required and then tighten all screws.

! CAUTION: Use the expansion bolt when there is a concrete wall surface. Use the clamping screw when there is a wooden wall surface.



1. Please insert your key to the lock carefully and turn it to left. Then you could turn the door handle to open the safe box.
2. Please keep your keys in a safe place when not in use. DON'T place your key in the safebox since the battery will run out and you could not open the safe box.
3. If your safe box doesn't response to the password, please open the safe box using your key and reset your battery.

If it does not work, please open the battery cover and check whether the lines connected properly.

EC	REP	Informationen für EU -Vertreter
Name:		Pegasus Trading GmbH
Adresse:		Sperberweg 4G Neuss NRW 41468 Germany
E-mail:		info@apex-ce.com
		

For any help, kindly consult the local distributor